

**NOTICE!!**

**These documents have been scanned!**

**Do not place un-scanned documents beneath this notice!**

**Do not remove this notice from this file!**

GPO Jacket No. 560-102  
Print Order 61540  
Rise Business Services, LLC  
Job=AZ15 5/10/2019



Box Number= AZ15030



Claim Begin-End: AMC430042-AMC430046

1 Initial Receipt



AZ15030-6

AMC429998-AMC430297



**United States Department of the Interior**  
**Bureau of Land Management**  
 LANDS/RECREATION & PLANNING  
 ONE N CENTRAL AVE  
 PHOENIX, AZ 85004 -2203  
 Phone: 602-417-9200

Receipt

No: 3181360

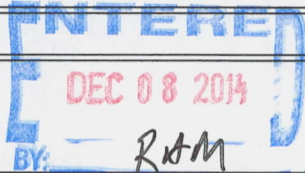
<b>Transaction #:</b> 3274370	
<b>Date of Transaction:</b> 12/02/2014	
CUSTOMER:	
DAVID RITTER 13475 S BELL RD BENSON, AZ 85602-7322 US	

LINE #	QTY	DESCRIPTION	REMARKS	UNIT PRICE	TOTAL
1	5.00	LOCATABLE MINERALS / MINING CLAIMS-NEW, UNADJUD, ONE OR MORE AUTH NOS / NEW MINING CLAIMS LOCATION FEE <b>CASES:</b> AMC430042/\$37.00, AMC430043/\$37.00, AMC430044/\$37.00, AMC430045/\$37.00, AMC430046/\$37.00		- n/a -	185.00
2	5.00	LOCATABLE MINERALS / MINING CLAIMS-NEW, UNADJUD, ONE OR MORE AUTH NOS / NEW MINING CLAIM PROCESSING FEE <b>CASES:</b> AMC430042/\$20.00, AMC430043/\$20.00, AMC430044/\$20.00, AMC430045/\$20.00, AMC430046/\$20.00		- n/a -	100.00
3	5.00	LOCATABLE MINERALS / MINING CLAIMS-NEW, UNADJUD, ONE OR MORE AUTH NOS / NEW MINING CLAIMS MAINTENANCE FEE <b>CASES:</b> AMC430042/\$155.00, AMC430043/\$155.00, AMC430044/\$155.00, AMC430045/\$155.00, AMC430046/\$155.00		- n/a -	775.00
4	1.00	LOCATABLE MINERALS / MINING CLAIMS-NOT NEW-UNADJUD, ONE AUTH NO. ONLY / MINING CLAIM MONEY RECEIVED <b>CASES:</b> AMC430042/\$155.00	NEW ASSOC PLACER LOCATION	- n/a -	155.00
<b>TOTAL:</b>					<b>\$1,215.00</b>

PAYMENT INFORMATION

12/2/14

1	AMOUNT:	367.00	POSTMARKED:	11/28/2014
	TYPE:	CHECK	RECEIVED:	12/01/2014
	CHECK NO:	114		
	NAME:	RITTER, DAVID 13475 S BELL RD BENSON AZ 85602-7322 US		
2	AMOUNT:	212.00	POSTMARKED:	11/28/2014
	TYPE:	CHECK	RECEIVED:	12/01/2014
	CHECK NO:	115		
	NAME:	RITTER, DAVID 13475 S BELL RD BENSON AZ 85602-7322 US		
3	AMOUNT:	212.00	POSTMARKED:	11/28/2014
	TYPE:	CHECK	RECEIVED:	12/01/2014
	CHECK NO:	116		
	NAME:	RITTER, DAVID 13475 S BELL RD BENSON AZ 85602-7322 US		
4	AMOUNT:	212.00	POSTMARKED:	11/28/2014
	TYPE:	CHECK	RECEIVED:	12/01/2014
	CHECK NO:	117		
	NAME:	RITTER, DAVID 13475 S BELL RD BENSON AZ 85602-7322 US		
5	AMOUNT:	212.00	POSTMARKED:	11/28/2014
	TYPE:	CHECK	RECEIVED:	12/01/2014
	CHECK NO:	118		
	NAME:	RITTER, DAVID 13475 S BELL RD BENSON AZ 85602-7322 US		

REMARKS

This receipt was generated by the automated BLM Collections and Billing System and is a paper representation of a portion of the official electronic record contained therein.

**NOTICE!!**

**These documents have been scanned!**

**Do not place un-scanned documents beneath this notice!**

**Do not remove this notice from this file!**

GPO Jacket No. 560-102  
Print Order 61540  
Rise Business Services, LLC  
Job=AZ15 5/10/2019



Box Number= AZ15030



Claim Begin-End: AMC430042-AMC430046

2 Correspondence



AZ15030-6

AMC429998-AMC430297



# United States Department of the Interior

BUREAU OF LAND MANAGEMENT

Arizona State Office

One North Central Avenue, Suite 800

Phoenix, Arizona 85004-4427

[www.blm.gov/az/](http://www.blm.gov/az/)



**JUL 16 2015**

In Reply Refer To:  
3800 (9310) RE  
AMC430042

CERTIFIED MAIL - RETURN RECEIPT REQUESTED No. 7014 0150 0000 5453 1334

## NOTICE

DAVID RITTER  
50 GUINEVERE CT  
LAFAYETTE, IN 47905-9692

:  
:  
:

This Notice Affects the Claims  
Shown in the Block Below.

---

AMC430042 - AMC430046  
GV RENEGADE 1 - GV RENEGADE 4

---

### Mining Claim Location Notices – Corrections Required

Pursuant to Title 43 Code of Federal Regulations (CFR) 3832.1, this office received your notice(s) of location for recordation of mining claims. In accordance with 43 CFR 3832.11 and 3832.12, the claim(s) listed above are not properly located. Because they are not properly located we cannot record them as filed. They must be corrected as noted below or they will be declared null and void ab initio.

No location date was provided.

You must provide the requested information for each claim listed above to correct the defects. Please do this by providing a copy of your location notice with the appropriate corrections, and note at the top of the form that it is a "Corrected Copy of Location Notice". If it is only the map that is missing or needs to be corrected, please provide the map. If the information is not received within the 30-day timeframe, the mining claims will be declared null and void ab initio.

**SENDER: COMPLETE THIS SECTION**

- Complete items 1, 2, and 3. Also complete item 4 if Restricted Delivery is desired.
- Print your name and address on the reverse so that we can return the card to you.
- Attach this card to the back of the mailpiece, or on the front if space permits.

1. Article Addressed to:

DAVID RITTER  
 50 GUINEVERE CT  
 LAFAYETTE, IN 47905-9692  
 9310/ADJ/RE/AMC430042

2. Article Number

*(Transfer from service label)*

7014 0150 0000 5453 1334

**COMPLETE THIS SECTION ON DELIVERY**

A. Signature

X

*Desubert* Agent AddresseeB. Received by *(Printed Name)*RECEIVED  
BLM AZ STATE OFFICE

C. Date of Delivery

7/23/15

D. Is delivery address different from item 1?  Yes No

If YES, enter delivery address below:

2015 JUL 28 P 3:27

PHOENIX, ARIZONA

3. Service Type

 Certified Mail® Priority Mail Express™ Registered Return Receipt for Merchandise Insured Mail Collect on Delivery4. Restricted Delivery? *(Extra Fee)* Yes

UNITED STATES POSTAL SERVICE

INDIANAPOLIS

IN 460

23 JUL '15

PM 11

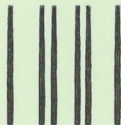

First-Class Mail  
Postage & Fees Paid  
USPS  
Permit No. G-10

- Sender: Please print your name, address, and ZIP+4® in this box•

UNITED STATES  
DEPARTMENT OF THE INTERIOR  
Bureau of Land Management  
Arizona State Office  
One N. Central Avenue, Suite 800  
Phoenix, AZ 85004-4427

004442700

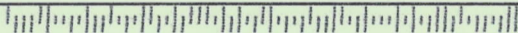



If additional information is required, please contact Rod Ebert at 602-417-9397. Please include your AMC serial number(s) on all correspondence.

Sincerely,

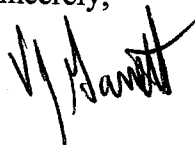

*for* Rebecca Heick  
Acting Deputy State Director  
Lands & Minerals Division

Enclosure:  
Location Notice(s)



# United States Department of the Interior

BUREAU OF LAND MANAGEMENT  
Arizona State Office  
One North Central Avenue, Suite 800  
Phoenix, Arizona 85004-4427  
www.blm.gov/az/



**JUL 16 2015**

In Reply Refer To:  
3800 (9310) RE  
AMC430042

CERTIFIED MAIL - RETURN RECEIPT REQUESTED No. 7014 0150 0000 5453 1341

### NOTICE

LEROY RITTER  
13475 S BELL RD  
BENSON, AZ 85602

:  
:  
:  
:

This Notice Affects the Claims  
Shown in the Block Below.

---

AMC430042 - AMC430046  
GV RENEGADE 1 - GV RENEGADE 4

---

### Mining Claim Location Notices – Corrections Required

Pursuant to Title 43 Code of Federal Regulations (CFR) 3832.1, this office received your notice(s) of location for recordation of mining claims. In accordance with 43 CFR 3832.11 and 3832.12, the claim(s) listed above are not properly located. Because they are not properly located we cannot record them as filed. They must be corrected as noted below or they will be declared null and void ab initio.

No location date was provided.

You must provide the requested information for each claim listed above to correct the defects. Please do this by providing a copy of your location notice with the appropriate corrections, and note at the top of the form that it is a "Corrected Copy of Location Notice". If it is only the map that is missing or needs to be corrected, please provide the map. If the information is not received within the 30-day timeframe, the mining claims will be declared null and void ab initio.

**SENDER: COMPLETE THIS SECTION**

- Complete items 1, 2, and 3. Also complete item 4 if Restricted Delivery is desired.
- Print your name and address on the reverse so that we can return the card to you.
- Attach this card to the back of the mailpiece, or on the front if space permits.

1. Article Addressed to:

LEROY RITTER  
 13475 S BELL RD  
 BENSON, AZ 85602  
 9310/ADJ/RE/AMC430042

RECEIVED  
 BLM AZ STATE OFFICE

2015 JUL 20

PHOENIX, ARIZONA

**COMPLETE THIS SECTION ON DELIVERY**

A. Signature

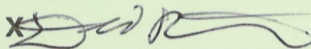

- Agent  
 Addressee

B. Received by (Printed Name)

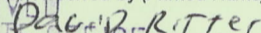
  
 Leroy Ritter

C. Date of Delivery

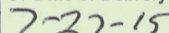
  
 7-27-15

D. Is delivery address different from item 1?  Yes

If YES, enter delivery address below:

No

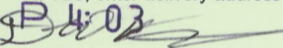
  
 P 4: 03

3. Service Type

- Certified Mail®     Priority Mail Express™  
 Registered         Return Receipt for Merchandise  
 Insured Mail         Collect on Delivery

4. Restricted Delivery? (Extra Fee)

Yes

2. Article Number

(Transfer from service label)

7014 0150 0000 5453 1341

UNITED STATES POSTAL SERVICE

AZ 852

27 JUL '15

FN 2 L



First-Class Mail  
Postage & Fees Paid  
USPS  
Permit No. G-10

- Sender: Please print your name, address, and ZIP+4® in this box•

UNITED STATES  
DEPARTMENT OF THE INTERIOR  
Bureau of Land Management  
Arizona State Office  
One N. Central Avenue, Suite 800  
Phoenix, AZ 85004-4427

4442700

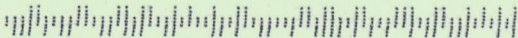

If additional information is required, please contact Rod Ebert at 602-417-9397. Please include your AMC serial number(s) on all correspondence.

Sincerely,

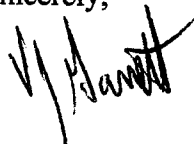

Rebecca Heick  
Acting Deputy State Director  
Lands & Minerals Division



Enclosure:  
Location Notice(s)

**NOTICE!!**

**These documents have been scanned!**

**Do not place un-scanned documents beneath this notice!**

**Do not remove this notice from this file!**

GPO Jacket No. 560-102  
Print Order 61540  
Rise Business Services, LLC  
Job=AZ15 5/10/2019



Box Number= AZ15030



Claim Begin-End: AMC430042-AMC430046

3 Transfers



AZ15030-6

AMC429998-AMC430297

**NO  
DOCUMENTS  
FOUND**

NO DOCUMENTS FOUND  
NO DOCUMENTS FOUND

**NOTICE!!**

**These documents have been scanned!**

**Do not place un-scanned documents beneath this notice!**

**Do not remove this notice from this file!**

GPO Jacket No. 560-102  
Print Order 61540  
Rise Business Services, LLC  
Job=AZ15 5/10/2019



Box Number= AZ15030



Claim Begin-End: AMC430042-AMC430046

4 Annual Filings



AZ15030-6

AMC429998-AMC430297



DEPARTMENT OF THE INTERIOR  
BUREAU OF LAND MANAGEMENT  
MINING CLAIMS

Run Date/Time: 8/20/2018

MC Maintenance Fees Paid Through the BLM Pay Portal  
(by Date Paid)

Page 232 Of 316

**CBS Receipt: 4236466**

Printed For Lead File # AMC430042

Agency Tracking ID: 1534343677

Assessment Year: 2019

Number of BLM Serial Nr: 7

Paid On: 8/15/2018

Total Amount Paid: \$1,240.00

Claim Name	BLM Serial No	Lead File No	Amount Paid
CLYDE	AMC423143	AMC423142	\$155.00
HIDDEN APPACHE	AMC423706	AMC423705	\$155.00
GV RENEGADE 1	AMC430042	AMC430042	\$310.00
GV RENEGADE 2	AMC430043	AMC430042	\$155.00
GV RENEGADE 3	AMC430044	AMC430042	\$155.00
GV RENEGADE 4	AMC430045	AMC430042	\$155.00
GV RENEGADE 5	AMC430046	AMC430042	\$155.00

**United States Department of the Interior**  
**Bureau of Land Management**  
 BUSINESS & SUPPORT SVCS DIV  
 ONE N CENTRAL AVE SUITE 800  
 PHOENIX, AZ 85004 -4427  
 Phone: 602-417-9200

Receipt

No: 4236466

<b>Transaction #:</b> 4351838	
<b>Date of Transaction:</b> 08/15/2018	
CUSTOMER:	
LEROY RITTER 3571 E CHAUNCEY CT LAFAYETTE,IN 47905 US	

LINE #	QTY	DESCRIPTION	REMARKS	UNIT PRICE	TOTAL
1	1.00	LOCATABLE MINERALS / MINING CLAIMS- NOT NEW-UNADJUD,ONE AUTH NO. ONLY / MINING CLAIM MONEY RECEIVED CASES: AMC423143/\$1240.00		- n/a -	1240.00
<b>TOTAL:</b>					<b>\$1,240.00</b>

PAYMENT INFORMATION			
NOTE: Items will appear on credit card statement as "BLM O Mining Claim".			
1	AMOUNT:	1240.00	POSTMARKED: N/A
	TYPE:	CREDIT CARD	RECEIVED: 08/15/2018
	NAME:	LEROY RITTER 3571 E CHAUNCEY CT LAFAYETTE IN 47905 US	
	CARD NO:	XXXXXXXXXXXX2070	AUTH CODE: 04526B
	NAME ON CARD:	LEROY RITTER	
	SIGNATURE:		

REMARKS

This receipt was generated by the automated BLM Collections and Billing System and is a paper representation of a portion of the official electronic record contained therein.

AMC 430042

2017-23-92

Page 1 of 2  
Requested By: David Ritter  
David W. Stevens - Recorder  
Cochise County, AZ  
12-11-2017 12:28 PM Recording Fee \$15.00

When Recorded Return Document to:  
David Ritter  
13475 S Bell Rd  
Benson Az 85602

Check here is this is a change of address.

Telephone: \_\_\_\_\_

E-mail address: \_\_\_\_\_

**AFFIDAVIT OF PERFORMANCE OF ANNUAL WORK**

1. State of Arizona, County of Cochise ss:  
2. I (Name) David Ritter  
3. Reside at (Address) 13475 S Bell Rd  
  
City Benson County Pima

RECEIVED  
PIMA AZ STATE OFFICE  
2017 DEC 12 A 10:48  
PHOENIX, ARIZONA  
BLM  
Date  
Stamp

State AZ Zip 85602 being duly sworn, depose and say that I am a citizen of the United States, more than eighteen years of age, and that all of the facts set forth in this affidavit, subject to the provisions and penalties of 18 U.S.C. 1001 pertaining to the filing of false, fictitious, or fraudulent statements with the United States, are true and correct according to the best of my knowledge, information and belief.

4. Owner's name and address (If not shown in Items 1-3 above). \_\_\_\_\_

5. That I am personally acquainted with the mining claim(s). The work and improvements were made by and at the expense of the owner(s) of said claim(s). Said contiguous group of claims, listed on this document, are situated in the

(optional) Mining District; Cochise County, Arizona.

Line No.	AMC NUMBER	CLAIM/SITE NAME	COUNTY RECORDER DATA (If available)	TWP	RNG	SEC
1	0430042	GV Renegade 1		16	23	23
2	0430043	GV Renegade 2		16	23	23
3	0430044	GV Renegade 3		16	23	23
4	0430045	GV Renegade 4		16	23	23
5	0430046	GV Renegade 5		16	23	23
6						

Form: MCF108  
Revised July 2014  
Page 1 of 2

**ENTERED**  
DEC 18 2017  
BY: DM

RECEIVED  
 STATE OF ARIZONA  
 2017 DEC 12 A 10:48  
 PHOENIX, ARIZONA  
 BLM  
 Date  
 Stamp

7					
8					
9					
10					

6. That between the dates starting at 12 o'clock noon on September 1, 20 16 and ending at 12 o'clock noon on September 1, 20 17 at least \$ 3500 dollars worth of work and improvements were done and performed upon said claim(s) or upon one or more of a contiguous group of claims for the benefit of all, wholly or partly outside of a contiguous group of claims for the benefit of all, not including the location work.

7. That the following persons were employed to perform the work and improvements described herein: Tom Olson, Mikayla Ritter, Tesa Riedhead, Jenice Ritter

8. That the work and improvements performed were: Fencing & securing old mine shafts

9. Dated: 11-24-17 Signature: [Signature]

SUBSCRIBED AND SWORN TO before me, a Notary Public, this 24th day of November 20 17

By: Nancy Wolf Moore

Notary Public Nancy Wolf Moore

My Commission Expires 12/25/2017

 NANCY WOLF MOORE  
 Notary Public - State of Arizona  
 COCHISE COUNTY  
 My Commission Expires  
 December 25, 2019

Bureau of Land Management  
 Arizona State Office  
[www.blm.gov/az](http://www.blm.gov/az)

No. of Claims: 5 x \$10 = 50.00  
 Check No.: cash Init. EM  
 Receipt No.: 4040173  
 For BLM Use Only

**United States Department of the Interior**  
**Bureau of Land Management**  
 DIV OF LANDS, MINRLS & ENERGY  
 ONE N CENTRAL AVE  
 PHOENIX, AZ 85004 -4427  
 Phone: 602-417-9200

Receipt

No: 4040173

<b>Transaction #:</b> 4151397	
<b>Date of Transaction:</b> 12/12/2017	
<b>CUSTOMER:</b>	
DAVID RITTER 13475 S BELL RD BENSON, AZ 85602-7322 US	

LINE #	QTY	DESCRIPTION	REMARKS	UNIT PRICE	TOTAL
1	1.00	LOCATABLE MINERALS / MINING CLAIMS- NOT NEW-UNADJUD, ONE AUTH NO. ONLY / MINING CLAIM MONEY RECEIVED CASES: AMC430042/\$50.00	2017 POL (5)	- n/a -	50.00
<b>TOTAL:</b>					<b>\$50.00</b>

PAYMENT INFORMATION			
1	AMOUNT:	50.00	POSTMARKED: N/A
	TYPE:	CASH	RECEIVED: 12/12/2017
	NAME:	RITTER, DAVID 13475 S BELL RD BENSON AZ 85602-7322 US	

REMARKS

This receipt was generated by the automated BLM Collections and Billing System and is a paper representation of a portion of the official electronic record contained therein.

UNITED STATES  
DEPARTMENT OF THE INTERIOR  
BUREAU OF LAND MANAGEMENT

**MAINTENANCE FEE WAIVER CERTIFICATION**

FORM APPROVED  
OMB NO. 1004-0114  
Expires: January 31, 2020

SEE INSTRUCTIONS ON PAGE 2

AMC 430042

555

PER

- This small miner waiver is filed for the assessment year beginning on September 1, 2017 and ending on September 1, 2018.
- The undersigned and all related parties owned ten or fewer mining claims, mill, or tunnel sites located and maintained on Federal lands in the United States of America on September 1, 2018.
- The undersigned have performed the assessment work required by law for each mining claim listed prior to filing this waiver and understand that by filing this form, the undersigned must file an affidavit of assessment work with the Bureau of Land Management (BLM) by the December 30th following the filing of this waiver.
- The undersigned understand that if the assessment work obligation has not yet come due under 30 U.S.C. 28 (for those claims in their first assessment year only), a notice of intent to hold reciting this condition must be recorded by the December 30th following the filing of this waiver.
- The undersigned understand that mill and tunnel sites may also be listed on this waiver and be waived from payment of the maintenance fee, and that a notice of intent to hold for these sites is required to be filed with the BLM by the December 30th following the filing of this waiver.
- The undersigned understand and acknowledge that pursuant to 43 U.S.C. 1212 and 18 U.S.C. 1001, the filing or recording of a false, fictitious, or fraudulent document with the BLM may result in a fine of up to \$250,000, a prison term not to exceed five years, or both.
- The mining claims, mill or tunnel sites for which this waiver from payment of the maintenance fees is requested are:

CLAIM OR SITE NAME	BLM RECORDATION SERIAL NUMBER
1. GV Renegade 1	AMC0430042
2. GV Renegade 2	AMC0430043
3. GV Renegade 3	AMC0430044
4. GV Renegade 4	AMC0430045
5. GV Renegade 5	AMC0430046
6.	
7.	
8.	
9.	
10.	

The owner(s) (claimants) of the above mining claims and sites are:

NW check  
5 cr

*David Ritter*

David Ritter  
 (Owner's Name - Please Print)

13475 S Bell Rd  
 (Owner's Mailing Address)

Tucson AZ 85602  
 (City) (State) (Zip Code)

7 cr

AC 170 entered  
Address updated  
9/20/17 PB

*Le Roy Ritter*

Le Roy Ritter  
 (Owner's Name - Please Print)

216 Heritage Road  
 (Owner's Mailing Address)

Monticello IN 47960  
 (City) (State) (Zip Code)

ENTERED  
 AC 483, AC 170  
 SEP 20 2017  
 BY: PB

PHOENIX, ARIZONA  
 2017 AUG 31 P 12:48  
 RECEIVED  
 BLM AZ STATE OFFICE

(Owner's Name - Please Print)

(Owner's Mailing Address)

(Owner's Name - Please Print)

(Owner's Mailing Address)

(Owner's Signature)

(City) (State) (Zip Code)

(Owner's Signature)

(City) (State) (Zip Code)

# Customer Name Update Screen

System ID:MC

Name: RITTER LE ROY

Proprietor #: 2350039

Renumber To:

Category: P - PRIVATE

Address: 216 HERITAGE RD

City: MONTICELLO

State: IN

Zip: 479601510

UNDELIVERABLE

No Annual Reminders

Email:

Phone:

**ENTERED**  
Ac 170  
SEP 20 2017  
Address Updated  
BY: PB per 2018 WVR

Customer details successfully saved for Customer Id 2350039

### Customer Name Update Screen

System ID:MC

Name:

Proprietor #:  Renumber To:

Category:

Address:  *PREVIOUS ADDRESS*

City:

State:

Zip:

UNDELIVERABLE  
 No Annual Reminders

Email:

Phone:



UNITED STATES DEPARTMENT OF THE INTERIOR  
BUREAU OF LAND MANAGEMENT

MC NATIONWIDE CLAIMANT LISTING  
September 20, 2017

Cust	AZ CLAIMANT	National Total
RITTER DAVID 13475 S BELL RD BENSON, AZ 85602-7322	5	5
RITTER LEROY 2136 N 900 E MONTICELLO, IN 47960-7414	1	1
RITTER LEROY 50 GUINEVERE CT LAFAYETTE, IN 47905-9692	7	7

Run Date: 09/08/16

Run Time: 12:27 PM

**DEPARTMENT OF THE INTERIOR  
BUREAU OF LAND MANAGEMENT  
MINING CLAIMS**

**MC Maintenance Fees Paid Through the BLM Pay Portal**

**CBS Receipt: 3636269**

Printed For Lead File # **AMC430042**

Agency Tracking ID: 1471689060

Assessment Year: 2017

Number of BLM Serial Nr: 8

Paid On: 08/20/2016

Total Amount Paid: \$1,395.00

Claim Name	BLM Serial No	Lead File No	Amount Paid
CLYDE	AMC423143	AMC423142	\$155.00
HIDDEN APPACHE	AMC423706	AMC423705	\$155.00
GV RENEGADE 1	AMC430042	AMC430042	\$310.00
GV RENEGADE 2	AMC430043	AMC430042	\$155.00
GV RENEGADE 3	AMC430044	AMC430042	\$155.00
GV RENEGADE 4	AMC430045	AMC430042	\$155.00
GV RENEGADE 5	AMC430046	AMC430042	\$155.00
NEW RIVER	AMC438191	AMC438189	\$155.00

**United States Department of the Interior**  
**Bureau of Land Management**  
 BUSINESS & SUPPORT SVCS DIV  
 ONE N CENTRAL AVE SUITE 800  
 PHOENIX, AZ 85004 -4427  
 Phone: (602) 417-9200

Receipt

No: 3636269

<b>Transaction #:</b> 3740122	
<b>Date of Transaction:</b> 08/20/2016	
<b>CUSTOMER:</b>	
LEROY E RITTER 2136 N 900 E MONTICELLO, AZ 47960 US	

LINE #	QTY	DESCRIPTION	REMARKS	UNIT PRICE	TOTAL
1	1.00	LOCATABLE MINERALS / MINING CLAIMS- NOT NEW-UNADJUD, ONE AUTH NO. ONLY / MINING CLAIM MONEY RECEIVED CASES: AMC423143/\$1395.00		- n/a -	1395.00
<b>TOTAL:</b>					<b>\$1,395.00</b>

PAYMENT INFORMATION					
NOTE: Items will appear on credit card statement as "BLM O Mining Claim".					
1	AMOUNT:	1395.00	POSTMARKED:	N/A	
	TYPE:	CREDIT CARD	RECEIVED:	08/20/2016	
	NAME:	LEROY E RITTER 2136 N 900 E MONTICELLO AZ 47960 US			
	CARD NO:	XXXXXXXXXXXX2070	AUTH CODE:	01756B	
	NAME ON CARD:	LEROY E RITTER			
	EXPIRES:	12/2020			
	SIGNATURE:				

REMARKS

This receipt was generated by the automated BLM Collections and Billing System and is a paper representation of a portion of the official electronic record contained therein.

Run Date: 08/27/15

Run Time: 08:15 AM

**DEPARTMENT OF THE INTERIOR  
BUREAU OF LAND MANAGEMENT  
MINING CLAIMS**

**MC Maintenance Fees Paid Through the BLM Pay Portal**

**CBS Receipt: 3370523**

Printed For Lead File # AMC430042

Agency Tracking ID: 1439871519

Number of BLM Serial Nr: 5

Assessment Year: 2016

Total Amount Paid: \$930.00

Paid On: 08/17/2015

Claim Name	BLM Serial No	Lead File No	Amount Paid
GV RENEGADE 1	AMC430042	AMC430042	\$310.00
GV RENEGADE 2	AMC430043	AMC430042	\$155.00
GV RENEGADE 3	AMC430044	AMC430042	\$155.00
GV RENEGADE 4	AMC430045	AMC430042	\$155.00
GV RENEGADE 5	AMC430046	AMC430042	\$155.00

**United States Department of the Interior**  
**Bureau of Land Management**  
 BUSINESS & SUPPORT SVCS DIV  
 ONE N CENTRAL AVE SUITE 800  
 PHOENIX, AZ 85004 -4427  
 Phone: (602) 417-9200

Receipt

No: 3370523

<b>Transaction #:</b> 3468678	
<b>Date of Transaction:</b> 08/18/2015	
<b>CUSTOMER:</b>	
JENICE RITTER 13475 S BELL RD BENSON, AZ 85602 US	

LINE #	QTY	DESCRIPTION	REMARKS	UNIT PRICE	TOTAL
1	1.00	LOCATABLE MINERALS / MINING CLAIMS- NOT NEW-UNADJUD, ONE AUTH NO. ONLY / MINING CLAIM MONEY RECEIVED CASES: AMC430045/\$930.00		- n/a -	930.00
<b>TOTAL:</b>					<b>\$930.00</b>

PAYMENT INFORMATION			
NOTE: Items will appear on credit card statement as "BLM O Mining Claim".			
1	AMOUNT:	930.00	POSTMARKED: N/A
	TYPE:	CREDIT CARD	RECEIVED: 08/18/2015
	NAME:	JENICE RITTER 13475 S BELL RD BENSON AZ 85602 US	
	CARD NO:	XXXXXXXXXXXX2089	AUTH CODE: 03705B
	NAME ON CARD:	JENICE RITTER	
	EXPIRES:	05/2018	
	SIGNATURE:		

REMARKS

This receipt was generated by the automated BLM Collections and Billing System and is a paper representation of a portion of the official electronic record contained therein.

**NOTICE!!**

**These documents have been scanned!**

**Do not place un-scanned documents beneath this notice!**

**Do not remove this notice from this file!**

GPO Jacket No. 560-102  
Print Order 61540  
Rise Business Services, LLC  
Job=AZ15 5/10/2019



Box Number= AZ15030



Claim Begin-End: AMC430042-AMC430046

5 Miscellaneous



AZ15030-6

AMC429998-AMC430297

RECEIVED  
BLM AZ STATE OFFICE

2015 AUG -6 P 2:48

PHOENIX, ARIZONA

Reference

cover letters

for each

Corrected location

notice filed 8-6-15

DR

8-12-15

10/1/2014

I, David E Ritter at 13475 S Bell Rd Benson Az  
85602 and Leroy E Ritter at 50 Guinevere Ct  
Lafayette In 47905 intend to Register this Claim  
in Cochise County.



David E Ritter

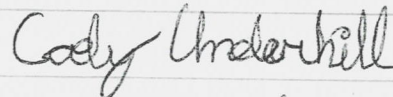

witnessed by Cody J Underhill

RECEIVED  
BLM AZ STATE OFFICE

2015 AUG -6 P 2:48

PHOENIX, ARIZONA

10/1/2014

I, David E Ritter at 13475 S Bell Rd Benson Az  
85602 and Leroy E Ritter at 50 Guinevere Ct  
Lafayette In 47905 intend to Register this Claim  
in Cochise County.

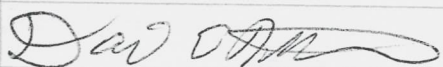

David E Ritter

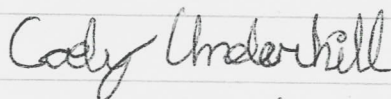

witnessed by Cody J Underhill



RECEIVED  
BLM AZ STATE OFFICE

2015 AUG -6 P 2:48

PHOENIX, ARIZONA

10/1/2014

I, David E Ritter at 13475 S Bell Rd Benson Az  
85602 and Leroy E Ritter at 50 Guinevere Ct  
Lafayette In 47905 intend to Register this Claim  
in Cochise County.

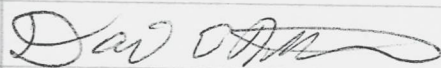

David E Ritter

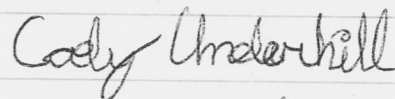

witnessed by Cody J Underhill

RECEIVED  
BLM AZ STATE OFFICE

2015 AUG -6 P 2:48

PHOENIX, ARIZONA

10/1/2014

I, David E Ritter at 13475 S Bell Rd Benson Az  
85602 and Leroy E Ritter at 50 Guinevere Ct  
Lafayette In 47905 intend to Register this Claim  
in Cochise County.



David E Ritter

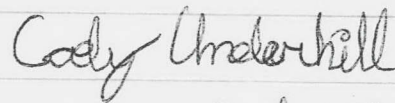

witnessed by Cody J Underhill

RECEIVED  
BLM AZ STATE OFFICE

2015 AUG -6 P 2:48

PHOENIX, ARIZONA

10/1/2014

I, David E Ritter at 13475 S Bell Rd Benson Az  
85602 and Leroy E Ritter at 50 Guinevere Ct  
Lafayette In 47905 intend to Register this Claim  
in Cochise County.



David E Ritter

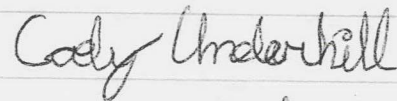

witnessed by Cody J Underhill

David E Ritter  
13475 S Bell Rd  
Benson AZ 85602

Leroy Ritter  
50 Guinevere Ct  
Lafayette In 47905

AMC430042

RECEIVED  
OFFICE

2014 DEC -1 P 3:17

PHOENIX, ARIZONA

**NOTICE!!**

**These documents have been scanned!**

**Do not place un-scanned documents beneath this notice!**

**Do not remove this notice from this file!**

GPO Jacket No. 560-102  
Print Order 61540  
Rise Business Services, LLC  
Job=AZ15 5/10/2019



Box Number= AZ15030



Claim Begin-End: AMC430042-AMC430046

6 Location Notices-Amendments and Supporting Documents



AZ15030-6

AMC429998-AMC430297

# MINING CLAIM STATUS REPORT

Data Entered: 12/08/14 Ram

MTP Checked By: 12/08/14 Ram  
GEO Checked By: 12/08/14 Ram

LEAD SERIAL NUMBER: AMC 430042 thru AMC 430046

### NUMBER OF CLAIMS & TYPE:

4 LODE  
\_\_\_\_ PLACER  
1 ASSOCIATION PLACER  
\_\_\_\_ MILL SITE  
\_\_\_\_ TUNNEL SITE

### CHARGES:

Location Fee @ \$37 = \$ 185.00  
Processing Fee @ \$20 = \$ 100.00  
Maintenance Fee @ \$155 = \$ 775.00  
Add'l Maint Fee for Assoc Placer = \$ 155.00  
**SUBTOTAL** \$ 1215.00  
Other Fees \$ ↓  
Other Fees \$ ↓  
**TOTAL** \$ 1215.00

TOTAL ACREAGE: 40 Per Claim  
(Placer Only)

NUMBER OF LOCATORS: 2

DOCUMENTS RECEIVED VIA: Over-the-Counter [ ] Mail  **TIMELY FILED:** Yes  No [ ]

LEGAL DESCRIPTION: T 16S R 23E SEC 23  
T \_\_\_\_\_ R \_\_\_\_\_ SEC \_\_\_\_\_  
T \_\_\_\_\_ R \_\_\_\_\_ SEC \_\_\_\_\_  
T \_\_\_\_\_ R \_\_\_\_\_ SEC \_\_\_\_\_  
T \_\_\_\_\_ R \_\_\_\_\_ SEC \_\_\_\_\_

BLM [ ] FOREST SERVICE [ ] \_\_\_\_\_ SUBJ TO PL 359: Yes [ ] No [ ]  
WILDERNESS AREA [ ] \_\_\_\_\_

SPLIT ESTATE: N/A [ ] SX [ ] PX [ ] OTHER [ ] \_\_\_\_\_  
SRHA [ ] Was proper Notice filed if located on SHRA Land? Yes [ ] No [ ]

### RECONVEYED MINERALS ON BLM LAND REQUIRE OPENING ORDER FROM 1944 TO 1993:

Open to Entry On \_\_\_\_\_ N/A [ ]

COMMENTS/STATUS: VOID [ ] PARTIALLY VOID [ ] PVT MINERALS [ ] WITHDRAWN LANDS [ ]  
OTHER [ ] \_\_\_\_\_

1. All claims - no date of location  
2. Accepted lodes as filed (w/o M&B) because placer claim is located & depicted as NWNE of section 23; claim map ~~shows~~ depicts the lodes as adjacent to the placer (AMC 430042 SW corner & SE corner are identical to NE corner of AMC 430044 & NW corner of AMC 430043). There is a rational weakness to the claimant's depiction of only one of the lode claims' corner could be identical to one of the placer's southern corner (unless there is a gap of 120 feet between AMC 430042 & -043 & between AMC 430044 & -045).

Printed Name of Claimant \_\_\_\_\_ Signature of Claimant \_\_\_\_\_

\*\*\*\*\*FINAL ADJUDICATION\*\*\*\*\*

DATE 6-2-15 INITIALS RE

AMC 430042

CORRECTED

LOCATION NOTICE FOR PLACER MINING CLAIM

NOTICE IS HEREBY GIVEN that the GU RENEGADE I

\_\_\_\_\_ placer mining claim has been located by

David Ritter whose current mailing

address is 13475 S Bell Rd

Benson Az 85602

BLM Date Stamp	PHOENIX, ARIZONA AUG 15 2015 P 3:16
----------------------	---

The general course of this claim is NORTH-SOUTH and it is situated in COCHISE County, Arizona.

This claim is 1320 feet in length and 1320 feet in width. This claim runs from the location monument on which this location notice is posted approximately 100 feet in a NORTH direction to the NORTH end line and 100 feet in a EAST direction to the EAST end line.

This claim is marked by four monuments, one at each corner of the claim.

The location monument on which this notice is posted is situated within Section 23, Township 16 SOUTH Range 23 EAST, Gila Salt River Base and Meridian, Arizona. This claim encompasses portions of the following legal subdivision(s) if located by legal subdivision or the following quarter section (s),

section (s), Township (s) and Range (s) NW-NE 1/4 SECTION 23

TOWNSHIP 16 SOUTH RANGE 23 EAST, Gila Salt River Base and Meridian, Arizona.

The locality of this claim with reference to some natural object or permanent monument and additional information (if any) concerning its locality are as follows: \_\_\_\_\_

DATED AND POSTED on the ground this 1 day of Oct, 20 14.

LOCATOR (s) David Ritter, Leahy Ritter  
David E. Ritter Leahy Ritter

RECEIVED  
BLM AZ STATE OFFICE  
PHOENIX ARIZONA  
AUG 15 2015  
P 2:48

Form MCF102  
Revised July 2005

This form is available from the Arizona Department of Mines & Mineral Resources and may be reproduced.

ENTERED  
AUG 15 2015  
BY: RS

AMC430042

MINING CLAIM MAP

Lode ( ) Placer

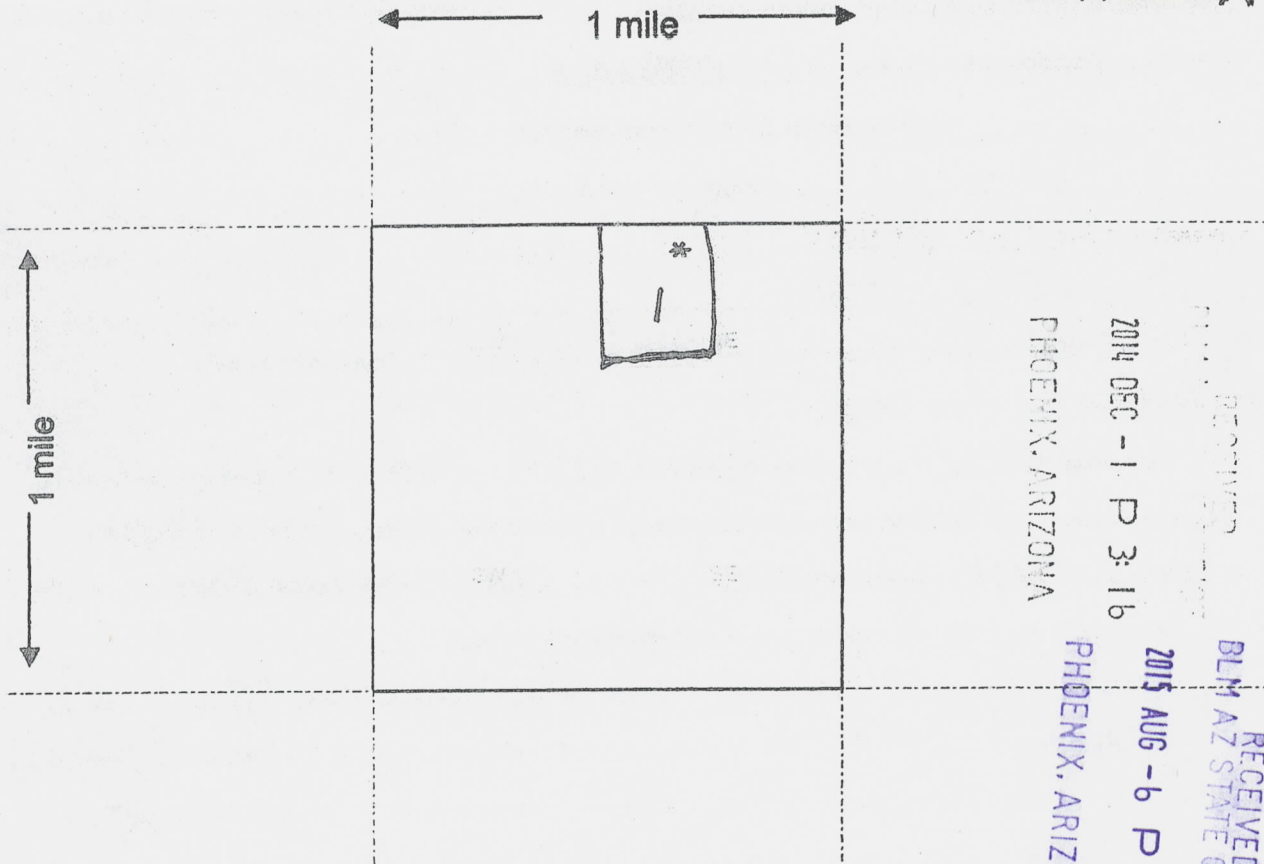

Scale : 1" = 2000 feet

RECEIVED  
BLM AZ STATE OFFICE  
2015 AUG - 6 P 2: 49  
PHOENIX, ARIZONA

RECEIVED  
2014 DEC - 1 P 3: 16  
PHOENIX, ARIZONA

AMC430042

1. The above map depicts the GU RENEGADE 1 mining claim, which is located in Section (s) 23, Township 16 South, Range 23 East, Gila and Salt River Base and Meridian, COCHISE County, Arizona.

2. The type of corner and location monuments used are as follows: 2 3/8" STEEL PINE  
4' LONG WITH CAPS

3. The bearings and distances in degrees and feet between claim corners are as depicted on the map.

180° 1320', 90° 1320', 360° 1320', 270° 1320'

Form MCF100a  
Revised July 2005



**LOCATION NOTICE FOR PLACER MINING CLAIM**

NOTICE IS HEREBY GIVEN that the GU RENEGADE I

\_\_\_\_\_ placer mining claim has been located by

David Ritter whose current mailing

address is 13475 S Bell Rd

Benson Az 85602

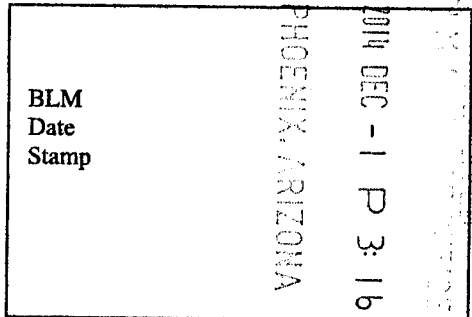

The general course of this claim is NORTH-SOUTH and it is situated in COCHISE County, Arizona.

This claim is 1320 feet in length and 1320 feet in width. This claim runs from the location monument on which this location notice is posted approximately 100 feet in a NORTH direction to the NORTH end line and 100 feet in a EAST direction to the EAST end line.

This claim is marked by four monuments, one at each corner of the claim.

The location monument on which this notice is posted is situated within Section 23, Township 16 SOUTH Range 23 EAST, Gila Salt River Base and Meridian, Arizona. This claim encompasses portions of the following legal subdivision(s) if located by legal subdivision or the following quarter section (s), section (s), Township (s) and Range (s) NW-NE 1/4 SECTION 23 TOWNSHIP 16 SOUTH RANGE 23 EAST, Gila Salt River Base and Meridian, Arizona.

The locality of this claim with reference to some natural object or permanent monument and additional information (if any) concerning its locality are as follows: \_\_\_\_\_

DATED AND POSTED on the ground this \_\_\_\_\_ day of \_\_\_\_\_, 20\_\_\_\_.

LOCATOR (s) David Ritter, LeRoy Ritter  
Stan E. Ritter LeRoy Ritter

Form MCF102  
Revised July 2005

This form is available from the Arizona Department of Mines & Mineral Resources and may be reproduced.

AMC430042

MINING CLAIM MAP

Lode ( ) Placer

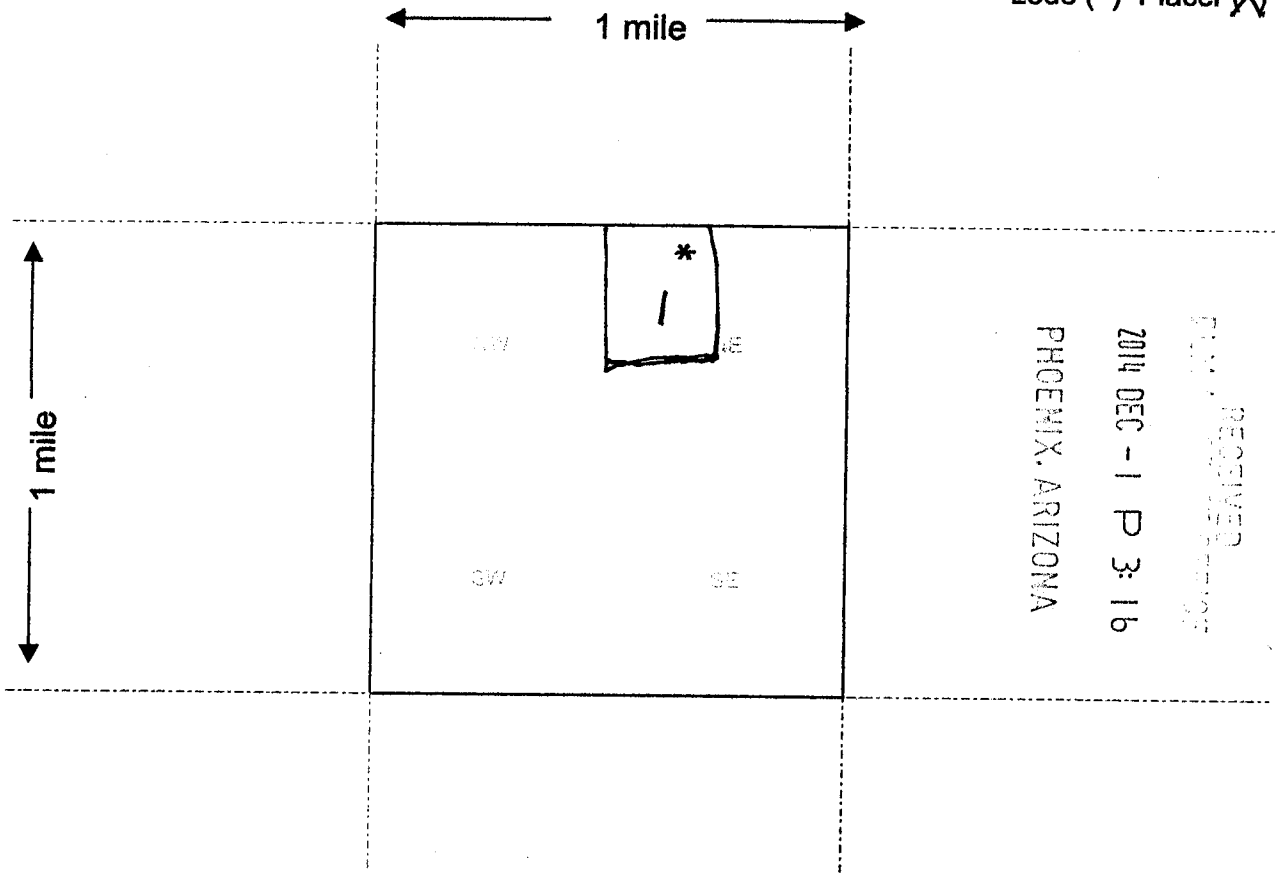

RECEIVED  
 2014 DEC - 1 P 3: 16  
 PHOENIX, ARIZONA

Scale : 1" = 2000 feet



1. The above map depicts the GU RENEGADE 1 mining claim, which is located in Section (s) 23, Township 16 South, Range 23 East, Gila and Salt River Base and Meridian, COCHISE County, Arizona.

2. The type of corner and location monuments used are as follows: 2 3/8" STEEL PINE  
4' LONG WITH CAPS

3. The bearings and distances in degrees and feet between claim corners are as depicted on the map.

180° 1320', 90° 1320', 360° 1320', 270° 1320'

Form MCF100a  
 Revised July 2005

This form is available from the Arizona Department of Mines & Mineral Resources and may be reproduced.

AMC430042

When recorded, mail to:

Name: David Ritter

Address: 13475 S Bell Rd

City/State/Zip Code: Benson Az 85602

Space above this line for Recorder's use

### NOTICE OF MINING CLAIM

- 1. TYPE OF NOTICE:  Location  Amendment  Relocation
- 2. TYPE OF CLAIM:  Placer  Lode  Millsite  Tunnelsite

3. The name and address of the Locator is

Name: David Ritter

Address: 13475 S Bell Rd

City/State/Zip Code: Benson Az 85602

4. The name of the claim is GV RENEGADE I

5. The date of the location is \_\_\_\_\_

6. The claim is 1320 feet long and 1320 feet wide. The distance from the location monument to each end of the claim is 1320 feet in a WEST direction and 1320 feet in a SOUTH direction.

7. The general course of the claim is from the EAST to the WEST

8. The location of the claim is in Section NW-NE 23, Township 16 SOUTH

Range 23 EAST

GILA SALT RIVER BASE

TERQUOISE

Base and Meridian, \_\_\_\_\_ County,

State of ARIZONA

Mining District, COCHISE

9. If amending or relocating, the previous claim name was \_\_\_\_\_

\_\_\_\_\_ recorded in Docket(Book) \_\_\_\_\_ page(s)

State of \_\_\_\_\_ Mining District, \_\_\_\_\_ County,

10. The location of the claim with reference to a natural object or permanent monument is \_\_\_\_\_

Dated: 10-7-2014

David Ritter

Signature

13475 S Bell Rd

Address

Benson Az 85602

City/State/Zip

AMC 430042

PHOENIX, ARIZONA  
2014 DEC -1 P 3:16

# MAP OF MINING CLAIM LOCATION

- The name of the claim is GV RENEGADE 1
- The NORTH EAST corner of the claim is 100 feet in a SOUTH WEST direction to a survey monument or permanent natural object described as 2 3/8" STEEL PIPE 4 FT. LONG WITH CAP
- The type of location monument is 2 3/8" STEEL PIPE 4 FT. LONG WITH CAP  
The type of corner end monuments are 2 3/8" STEEL PIPE 4 FT. LONG WITH CAP
- The bearing and distance between the corners of the claim are beginning at the NORTH EAST corner of the claim, 1320 feet in a WEST direction to the NORTH WEST corner, then 1320 feet in a SOUTH direction to the SOUTH WEST corner, then 1320 feet in a EAST direction to the SOUTH EAST corner, then 1320 feet in a NORTH direction to the point of beginning.

## MAP

One inch = One thousand feet

North Arrow



ONE MILE

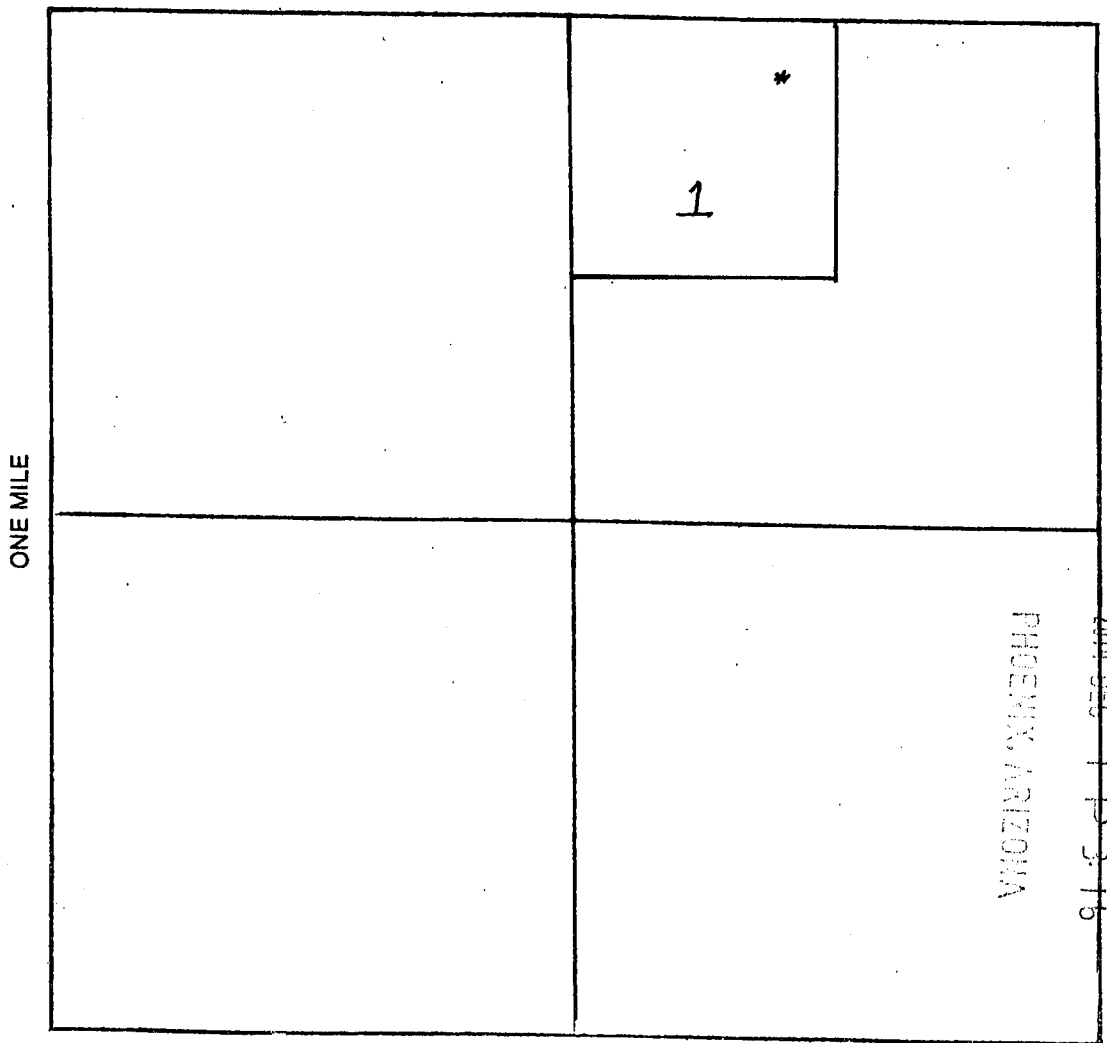

Section 23 Range 23 EAST Township 16 South  
GILA AND SALT RIVER Base and Meridian.

Dated: 10-07-2014

[Signature]  
Signature

CORRECTED

LOCATION NOTICE FOR LODE MINING CLAIM

NOTICE IS HEREBY GIVEN that the GV RENEGADE 2  
lode mining claim has been located  
by David Ritter whose current mailing  
address is 13475 S Bell Rd  
Benson Az 85716

BLM  
Date  
Stamp  
PHOENIX, ARIZONA  
DEC 1 P 3:16

The general course of this claim is NORTH-SOUTH and it is situated in COCHISE  
County, Arizona. This claim is 1500 feet in length and 600 feet in width. This claim runs  
from the location monument on which this location notice is posted approximately 10 feet in a  
SOUTH direction to the SOUTH end line and 300 feet in a EAST direction to the  
EAST end line. This claim is marked by six monuments, one at each corner and one at the center of each  
end line of the claim.

The location monument on which this notice is posted is situated within Section 23, Township 16  
South, Range 23 EAST, Gila Salt River Base and Meridian, Arizona and this claim encompasses portions  
of the following quarter section (s), section (s), Township (s) and Range (s) SW-NE 1/4, SECTION 23,  
TOWNSHIP 16 south, RANGE 23 EAST

Gila Salt River Base and Meridian, Arizona.

The locality of this claim with reference to some natural object or permanent monument and additional information  
(if any) concerning its locality are as follows:

DATED AND POSTED on the ground this 1 day of Oct, 2014.

LOCATOR (s) David Ritter, Leroy Ritter  
Low Est L. P. Ritter

RECEIVED  
BLM AZ STATE OFFICE  
2015 AUG - 6 P 2:48  
PHOENIX, ARIZONA

Form MCF100  
Revised July 2005

This form is available from the Arizona Department of Mines & Mineral Resources and may be reproduced.

ENTERED  
AUG 15 2015  
BY: RE

AMC430043

MINING CLAIM MAP

Lode (X) Placer ( )

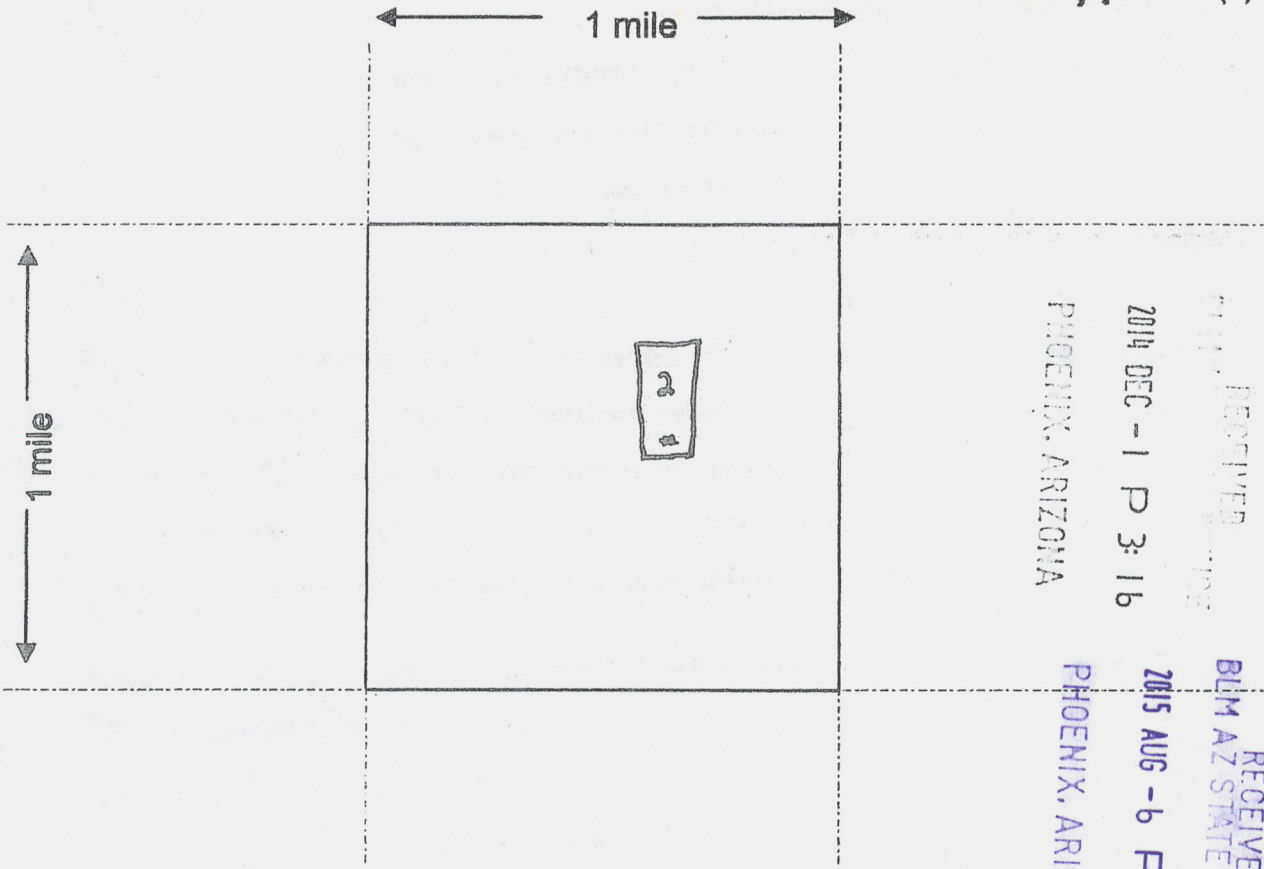

Scale : 1" = 2000 feet



RECEIVED  
BLM AZ STATE OFFICE  
2015 AUG - 6 P 2:49  
PHOENIX, ARIZONA

RECEIVED  
BLM AZ STATE OFFICE  
2014 DEC - 1 P 3:16  
PHOENIX, ARIZONA

AMC430043

1. The above map depicts the GV RENEGADE mining claim, which is located in Section (s) 23, Township 16 SOUTH, Range 23 EAST, Gila and Salt River Base and Meridian, COCHISE County, Arizona.

2. The type of corner and location monuments used are as follows: 2 3/8" STEEL PIPE  
4' LONG WITH CAPS

3. The bearings and distances in degrees and feet between claim corners are as depicted on the map.  
180° 1500', 90° 600', 360° 1500', 270° 600'

Form MCF100a  
Revised July 2005

**LOCATION NOTICE FOR LODE MINING CLAIM**

NOTICE IS HEREBY GIVEN that the GV RENEGADE 2  
\_\_\_\_\_ lode mining claim has been located  
by David Ritter whose current mailing  
address is 13475 S Bell Rd  
Benson Az 85716

BLM Date Stamp	2014 DEC -1 P 3:16 PHOENIX, ARIZONA
----------------------	--

The general course of this claim is NORTH-SOUTH and it is situated in COCHISE  
County, Arizona. This claim is 1500 feet in length and 600 feet in width. This claim runs  
from the location monument on which this location notice is posted approximately 10 feet in a  
SOUTH direction to the SOUTH end line and 300 feet in a EAST direction to the  
EAST end line. This claim is marked by six monuments, one at each corner and one at the center of each  
end line of the claim.

The location monument on which this notice is posted is situated within Section 23, Township 16  
SOUTH, Range 23 EAST, Gila Salt River Base and Meridian, Arizona and this claim encompasses portions  
of the following quarter section (s), section (s), Township (s) and Range (s) SW-NE 1/4, SECTION 23,  
TOWNSHIP 16 SOUTH, RANGE 23 EAST

Gila Salt River Base and Meridian, Arizona.

The locality of this claim with reference to some natural object or permanent monument and additional information  
(if any) concerning its locality are as follows: \_\_\_\_\_  
\_\_\_\_\_  
\_\_\_\_\_

DATED AND POSTED on the ground this \_\_\_\_\_ day of \_\_\_\_\_, 20\_\_\_\_.

LOCATOR (s) David Ritter, Leroy Ritter  
David Ritter Leroy Ritter

Form MCF100  
Revised July 2005

AM0430043

MINING CLAIM MAP

Lode (X) Placer ( )

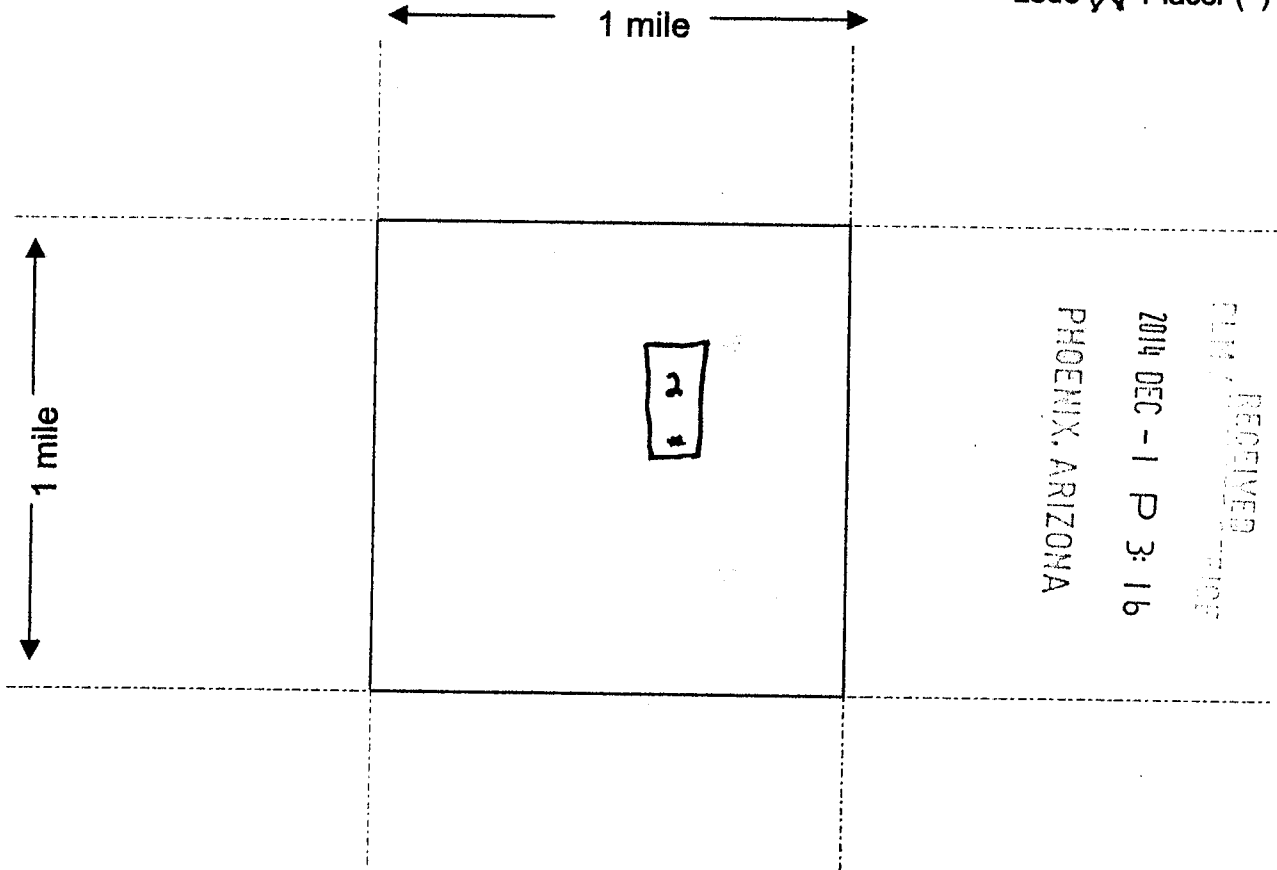

FILM RECEIVED  
 2014 DEC - 1 P 3: 16  
 PHOENIX, ARIZONA

ANCH 30043

Scale : 1" = 2000 feet



1. The above map depicts the GV RENEGADE mining claim, which is located in Section (s) 23, Township 16 SOUTH, Range 23 EAST, Gila and Salt River Base and Meridian, COCHISE County, Arizona.

2. The type of corner and location monuments used are as follows: 2 3/8" STEEL PIPE  
4' LONG WITH CAPS

3. The bearings and distances in degrees and feet between claim corners are as depicted on the map.

180° 1500', 90° 600', 360° 1500', 270° 600'

Form MCF100a  
Revised July 2005

This form is available from the Arizona Department of Mines & Mineral Resources and may be reproduced.



When recorded, mail to:

Name: David Ritter

Address: 13475 S Bell Rd

City/State/Zip Code: Benson Az 85602

Space above this line for Recorder's use

### NOTICE OF MINING CLAIM

- 1. TYPE OF NOTICE:  Location  Amendment  Relocation
- 2. TYPE OF CLAIM:  Placer  Lode  Millsite  Tunnelsite

3. The name and address of the Locator is

Name: David Ritter

Address: 13475 S Bell Rd

City/State/Zip Code: Benson Az 85602

4. The name of the claim is GV RENEGADE 2

5. The date of the location is \_\_\_\_\_

6. The claim is 1500 feet long and 600 feet wide. The distance from the location monument to each end of the claim is 1500 feet in a SOUTH direction and 600 feet in a EAST direction.

7. The general course of the claim is from the NORTH to the SOUTH

8. The location of the claim is in Section SW-NE 23, Township 16 SOUTH Range 23 EAST

GILA SALT RIVER  
TERQUISE

Base and Meridian,  
County,

State of ARIZONA Mining District, COCHISE

9. If amending or relocating, the previous claim name was \_\_\_\_\_

\_\_\_\_\_ recorded in Docket(Book) \_\_\_\_\_ page(s)

State of \_\_\_\_\_ Mining District, \_\_\_\_\_ County,

10. The location of the claim with reference to a natural object or permanent monument is \_\_\_\_\_

Dated: 10-07-2014

David Ritter  
Signature

13475 S Bell Rd  
Address

Benson Az 85602  
City/State/Zip

AMC 430043

RECORDED  
2014 DEC - 1 P 3 16  
COCHISE COUNTY, ARIZONA

# MAP OF MINING CLAIM LOCATION

1. The name of the claim is GV RENEGADE 2
2. The NORTH WEST corner of the claim is 600 feet in a EAST direction to a survey monument or permanent natural object described as \_\_\_\_\_
3. The type of location monument is 2 3/8" STEEL PIPE 4 FT. LONG WITH CAP  
The type of corner end monuments are 2 3/8" STEEL PIPE 4 FT. LONG WITH CAP
4. The bearing and distance between the corners of the claim are beginning at the NORTH EAST corner of the claim, 600 feet in a WEST direction to the NORTH WEST corner, then 1500 feet in a SOUTH direction to the SOUTHWEST corner, then 600 feet in a EAST direction to the SOUTHEAST corner, then 1500 feet in a NORTH direction to the point of beginning.

## MAP

One inch = One thousand feet

North Arrow



ONE MILE

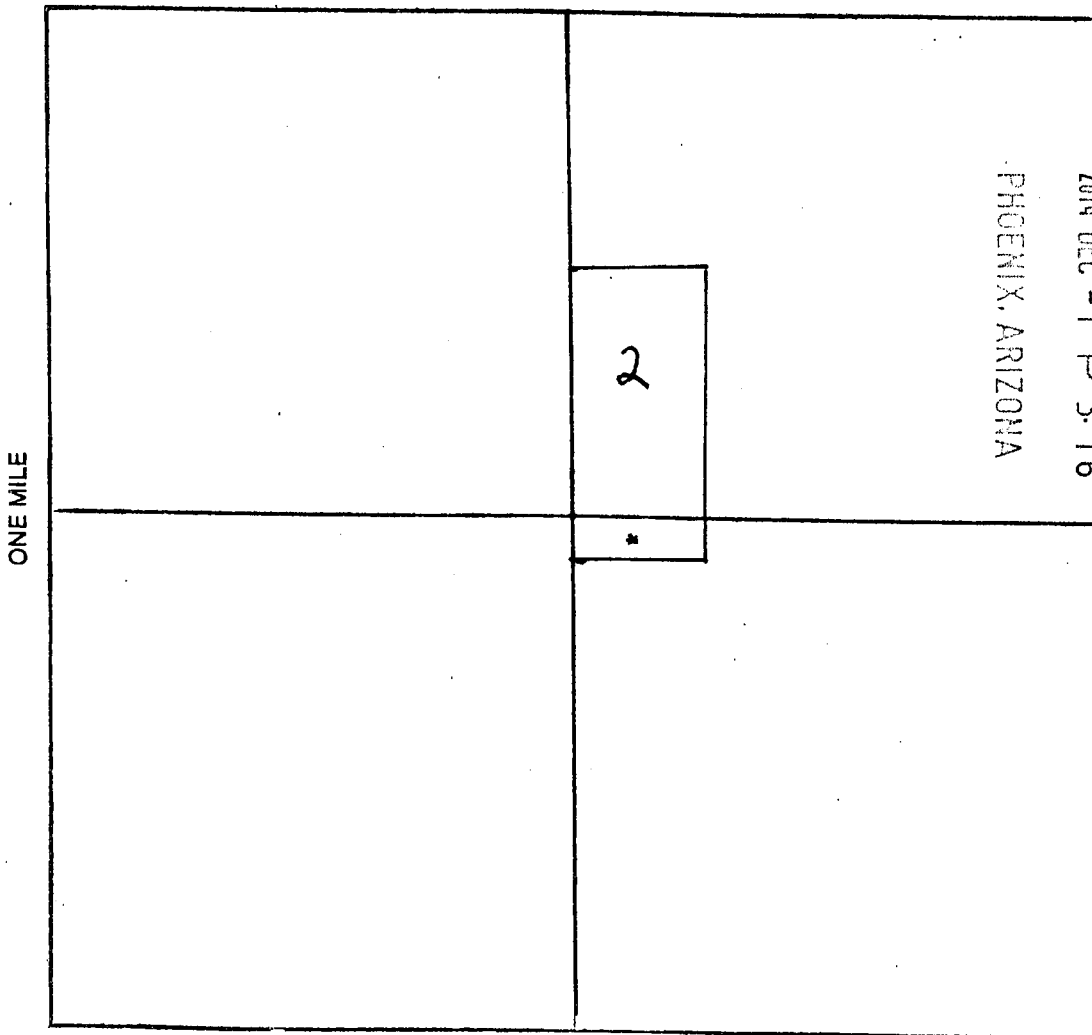

Section SW-NE 23 Range 23 EAST Township 16 SOUTH  
GILA SALT RIVER Base and Meridian.

Dated: 10-07-2014

Signature

CORRECTED

LOCATION NOTICE FOR LODE MINING CLAIM

NOTICE IS HEREBY GIVEN that the GU RENEGADE 3  
lode mining claim has been located  
by David Ritter whose current mailing  
address is 13475 S Bell Rd  
Benson Az 85602

RECEIVED  
2014 DEC - 1 P 3: 16  
PHOENIX, ARIZONA  
BLM  
Date  
Stamp

The general course of this claim is NORTH-SOUTH and it is situated in COCHISE  
County, Arizona. This claim is 1500 feet in length and 600 feet in width. This claim runs  
from the location monument on which this location notice is posted approximately 10 feet in a  
South direction to the South end line and 300 feet in a EAST direction to the  
EAST end line. This claim is marked by six monuments, one at each corner and one at the center of each  
end line of the claim.

The location monument on which this notice is posted is situated within Section 23, Township 16  
South, Range 23 East, Gila Salt River Base and Meridian, Arizona and this claim encompasses portions  
of the following quarter section (s), section (s), Township (s) and Range (s) SW-NE 1/4 SECTION 23  
TOWNSHIP 16 SOUTH, RANGE 23 EAST

Gila Salt River Base and Meridian, Arizona.

The locality of this claim with reference to some natural object or permanent monument and additional information  
(if any) concerning its locality are as follows:

DATED AND POSTED on the ground this 1 day of Oct, 2014.

LOCATOR (s) David Ritter, Leroy Ritter  
David Ritter Leroy Ritter

RECEIVED  
BLM AZ STATE OFFICE  
2015 AUG - 6 P 2: 48  
PHOENIX, ARIZONA  
Form MCF100  
Revised July 2005

-AMC430044

This form is available from the Arizona Department of Mines & Mineral Resources and may be reproduced.

ENTERED  
AUG 15 2015  
BY: RS

MINING CLAIM MAP

Lode (X) Placer ( )

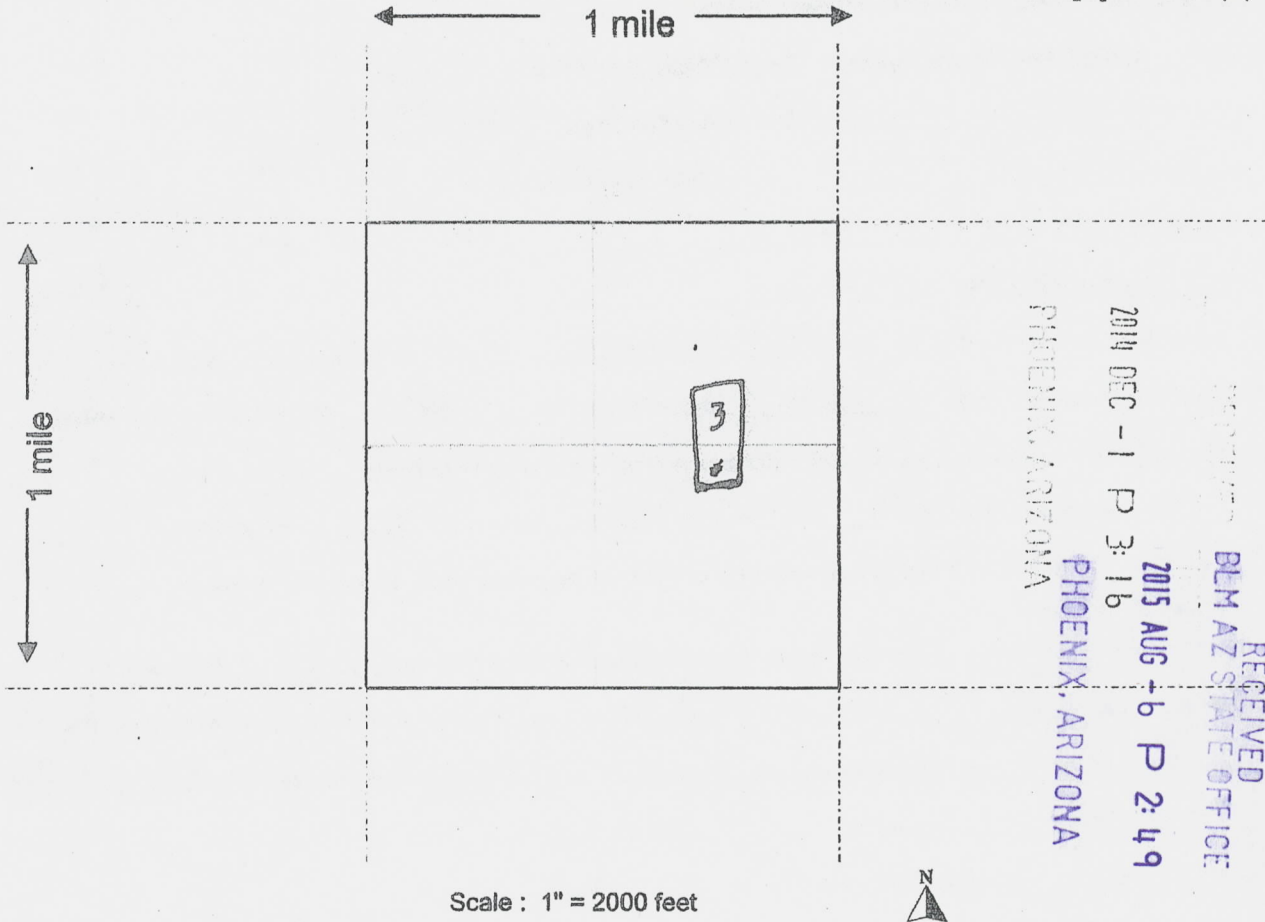

Scale : 1" = 2000 feet

RECEIVED  
BLM AZ STATE OFFICE  
2015 AUG - 6 P 2:49  
PHOENIX, ARIZONA  
2014 DEC - 1 P 3:16  
PHOENIX, ARIZONA

AMC 430044

1. The above map depicts the GV RENEGADE 3 mining claim, which is located in Section (s) 23, Township 16 SOUTH, Range 23 EAST, Gila and Salt River Base and Meridian, COCHISE County, Arizona.

2. The type of corner and location monuments used are as follows: 2 3/8" STEEL PIPE  
4' LONG WITH CAPS

3. The bearings and distances in degrees and feet between claim corners are as depicted on the map.

180° 1500', 90° 600', 360° 1500', 270° 600'

Form MCF100a  
Revised July 2005

This form is available from the Arizona Department of Mines & Mineral Resources and may be reproduced.

**LOCATION NOTICE FOR LODE MINING CLAIM**

NOTICE IS HEREBY GIVEN that the GU RENEGADE 3

\_\_\_\_\_ lode mining claim has been located

by David Ritter whose current mailing

address is 13475 S Bell Rd

Benson Az 85602

PHOENIX, ARIZONA	2014 DEC - 1 P 3: 16
BLM Date Stamp	

The general course of this claim is NORTH-SOUTH and it is situated in COCHISE County, Arizona. This claim is 1500 feet in length and 600 feet in width. This claim runs

from the location monument on which this location notice is posted approximately 10 feet in a

South direction to the South end line and 300 feet in a EAST direction to the

EAST end line. This claim is marked by six monuments, one at each corner and one at the center of each end line of the claim.

The location monument on which this notice is posted is situated within Section 23, Township 16

SOUTH, Range 23 EAST, Gila Salt River Base and Meridian, Arizona and this claim encompasses portions

of the following quarter section (s), section (s), Township (s) and Range (s) SW - NE 1/4 SECTION 23

TOWNSHIP 16 SOUTH, RANGE 23 EAST

Gila Salt River Base and Meridian, Arizona.

The locality of this claim with reference to some natural object or permanent monument and additional information (if any) concerning its locality are as follows: \_\_\_\_\_

DATED AND POSTED on the ground this \_\_\_\_\_ day of \_\_\_\_\_, 20\_\_\_\_.

LOCATOR (s) David Ritter, Leroy Ritter  
David Ritter Leroy Ritter

Form MCF100  
Revised July 2005

-AMC430044

MINING CLAIM MAP

Lode (X) Placer ( )

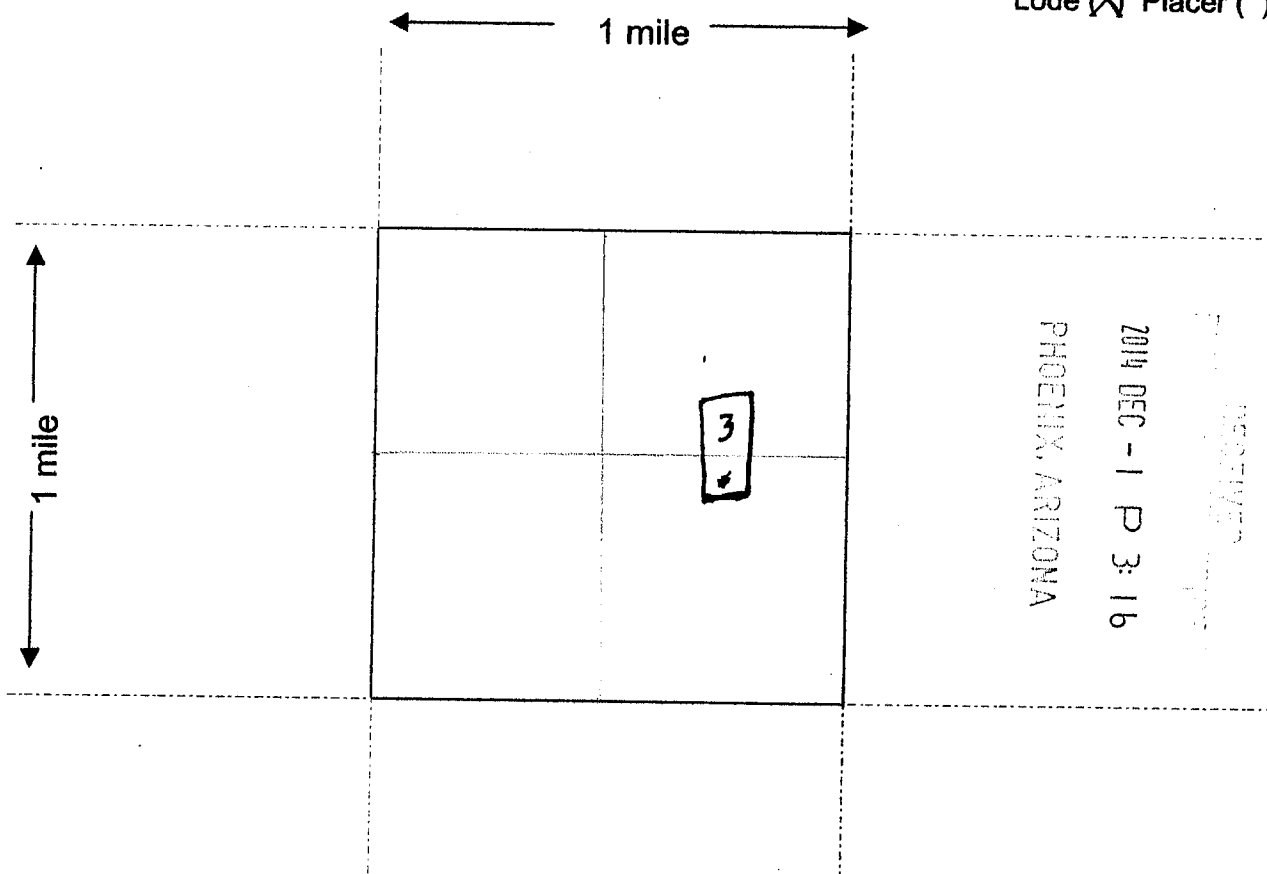

RECEIVED  
 2014 DEC - 1 P 3: 16  
 PHOENIX, ARIZONA

AMC430044

Scale : 1" = 2000 feet



1. The above map depicts the GV RENEGADE 3 mining claim, which is located in Section (s) 23, Township 16 South, Range 23 EAST, Gila and Salt River Base and Meridian, COCHISE County, Arizona.

2. The type of corner and location monuments used are as follows: 2 3/8" STEEL PIPE  
4' LONG WITH CAPS

3. The bearings and distances in degrees and feet between claim corners are as depicted on the map.

180° 1500', 90° 600', 360° 1500', 270° 600'

Form MCF100a  
 Revised July 2005

This form is available from the Arizona Department of Mines & Mineral Resources and may be reproduced.

Requester: David Ritter  
Christine [Barcode] - Recorder

Cochise County, AZ  
10-07-2014 08:58 AM Recording Fee \$9.00

When recorded, mail to:

Name: David Ritter

Address: 13475 S Bell Rd

City/State/Zip Code: Benson Az 85602

Space above this line for Recorder's use

### NOTICE OF MINING CLAIM

- 1. TYPE OF NOTICE:  Location  Amendment  Relocation
- 2. TYPE OF CLAIM:  Placer  Lode  Millsite  Tunnelsite

3. The name and address of the Locator is

Name: David Ritter

Address: 13475 S Bell Rd

City/State/Zip Code: Benson Az 85602

4. The name of the claim is GV RENEGADE 3

5. The date of the location is \_\_\_\_\_

6. The claim is 1500 feet long and 600 feet wide. The distance from the location monument to each end of the claim is 1500 feet in a SOUTH direction and 600 feet in a WEST direction.

7. The general course of the claim is from the NORTH to the SOUTH

8. The location of the claim is in Section SW-NE 1/4 23, Township 16 SOUTH

Range 23 EAST

GILA SALT RIVER

TERQUISE

Base and Meridian

State of ARIZONA

Mining District, COCHISE

County

9. If amending or relocating, the previous claim name was \_\_\_\_\_

\_\_\_\_\_ recorded in Docket(Book) \_\_\_\_\_ page(s) \_\_\_\_\_

State of \_\_\_\_\_ Mining District, \_\_\_\_\_ County,

10. The location of the claim with reference to a natural object or permanent monument is \_\_\_\_\_

Dated: 10-07-2014

David Ritter  
Signature

13475 S Bell Rd  
Address

Benson Az 85602  
City/State/Zip

PHOENIX, ARIZONA  
2014 DEC - 1 03:17

# MINING CLAIM LOCATION

- The name of the claim is GV RENEGADE 3
- The NORTH EAST corner of the claim is 600 feet in a EAST direction to a survey monument or permanent natural object described as \_\_\_\_\_
- The type of location monument is 2 3/8" STEEL PIPE 4 FT LONG WITH CAP  
The type of corner end monuments are 2 3/8" STEEL PIPE 4 FT LONG WITH CAP
- The bearing and distance between the corners of the claim are beginning at the NORTH EAST corner of the claim, 600 feet in a WEST direction to the NORTH WEST corner, then 1500 feet in a SOUTH direction to the SOUTH WEST corner, then 600 feet in a EAST direction to the SOUTH EAST corner, then 1500 feet in a NORTH direction to the point of beginning.

## MAP

One inch = One thousand feet

North Arrow



ONE MILE

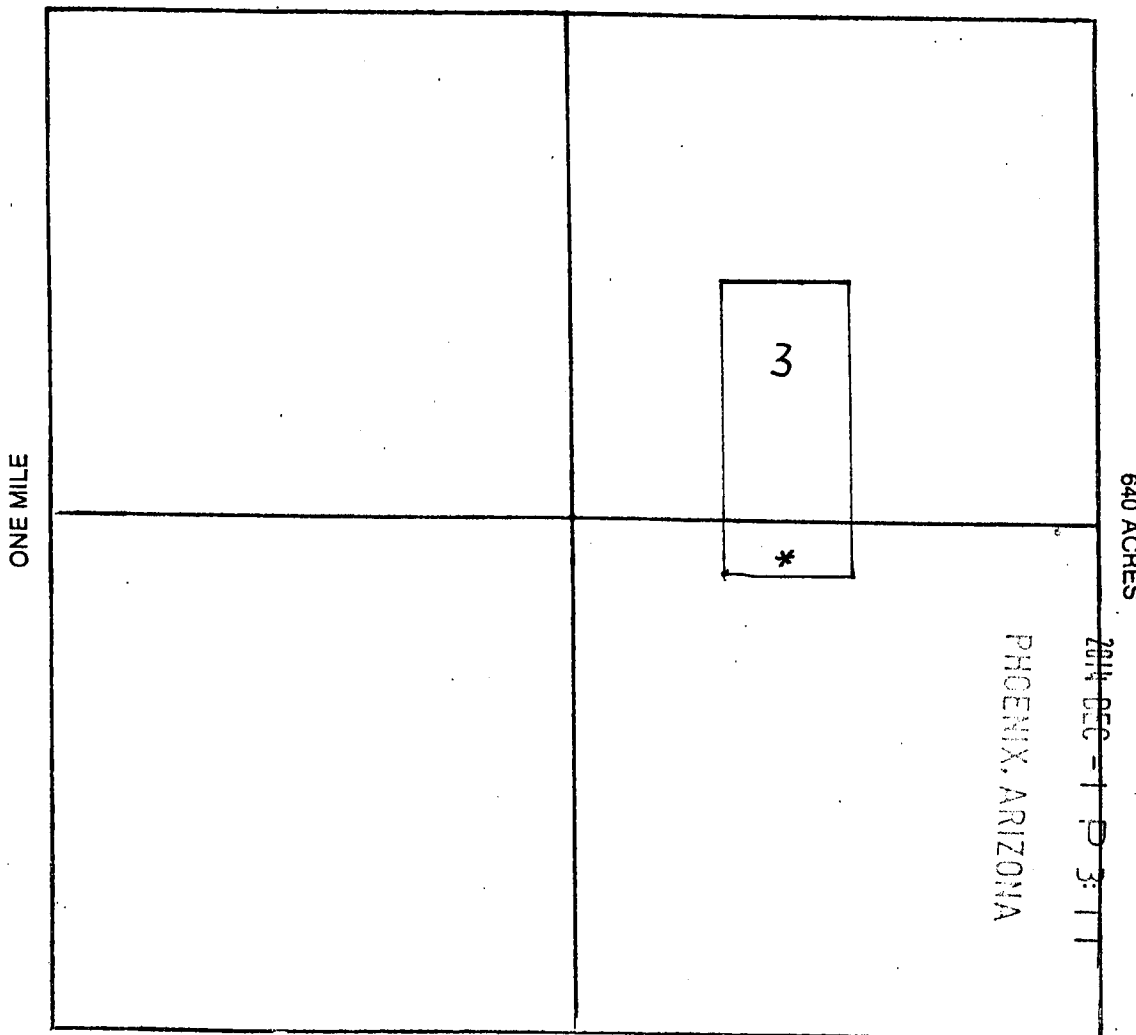

AMC 430044

Section SW-NE 1/4 23 Range 23 EAST Township 16 South  
GILA RIVER SALT RIVER Base and Meridian.

Dated: 10-07-2014

[Signature]

Signature



CORRECTED  
**LOCATION NOTICE FOR LODE MINING CLAIM**

NOTICE IS HEREBY GIVEN that the GV RENEGADE 5  
\_\_\_\_\_ lode mining claim has been located  
by David Ritter whose current mailing  
address is 13475 S Bell Rd  
Benson Az 85602

BLM  
Date  
Stamp  
2014 DEC - 1 P 3:17  
PHOENIX, ARIZONA  
RECEIVED

The general course of this claim is NORTH - SOUTH and it is situated in COCHISE  
County, Arizona. This claim is 1500 feet in length and 600 feet in width. This claim runs  
from the location monument on which this location notice is posted approximately 10 feet in a  
SOUTH direction to the SOUTH end line and 300 feet in a EAST direction to the  
EAST end line. This claim is marked by six monuments, one at each corner and one at the center of each  
end line of the claim.

The location monument on which this notice is posted is situated within Section 23, Township 16  
SOUTH, Range 23 EAST, Gila Salt River Base and Meridian, Arizona and this claim encompasses portions  
of the following quarter section (s), section (s), Township (s) and Range (s) NW - SE 1/4 SECTION 23  
TOWNSHIP 16 SOUTH, RANGE 23 EAST

Gila Salt River Base and Meridian, Arizona.

The locality of this claim with reference to some natural object or permanent monument and additional information  
(if any) concerning its locality are as follows: \_\_\_\_\_

**DATED AND POSTED** on the ground this 1 day of Oct, 2014.

LOCATOR (s) David Ritter, Leroy Ritter  
David Ritter, Leroy Ritter

RECEIVED  
BLM AZ STATE OFFICE  
2015 AUG - 6 P 2:47  
PHOENIX, ARIZONA  
Form MCFD00  
Revised July 2005

AMC430046

**ENTERED**  
AUG 13 2015  
BY: RS

MINING CLAIM MAP

Lode (X) Placer ( )

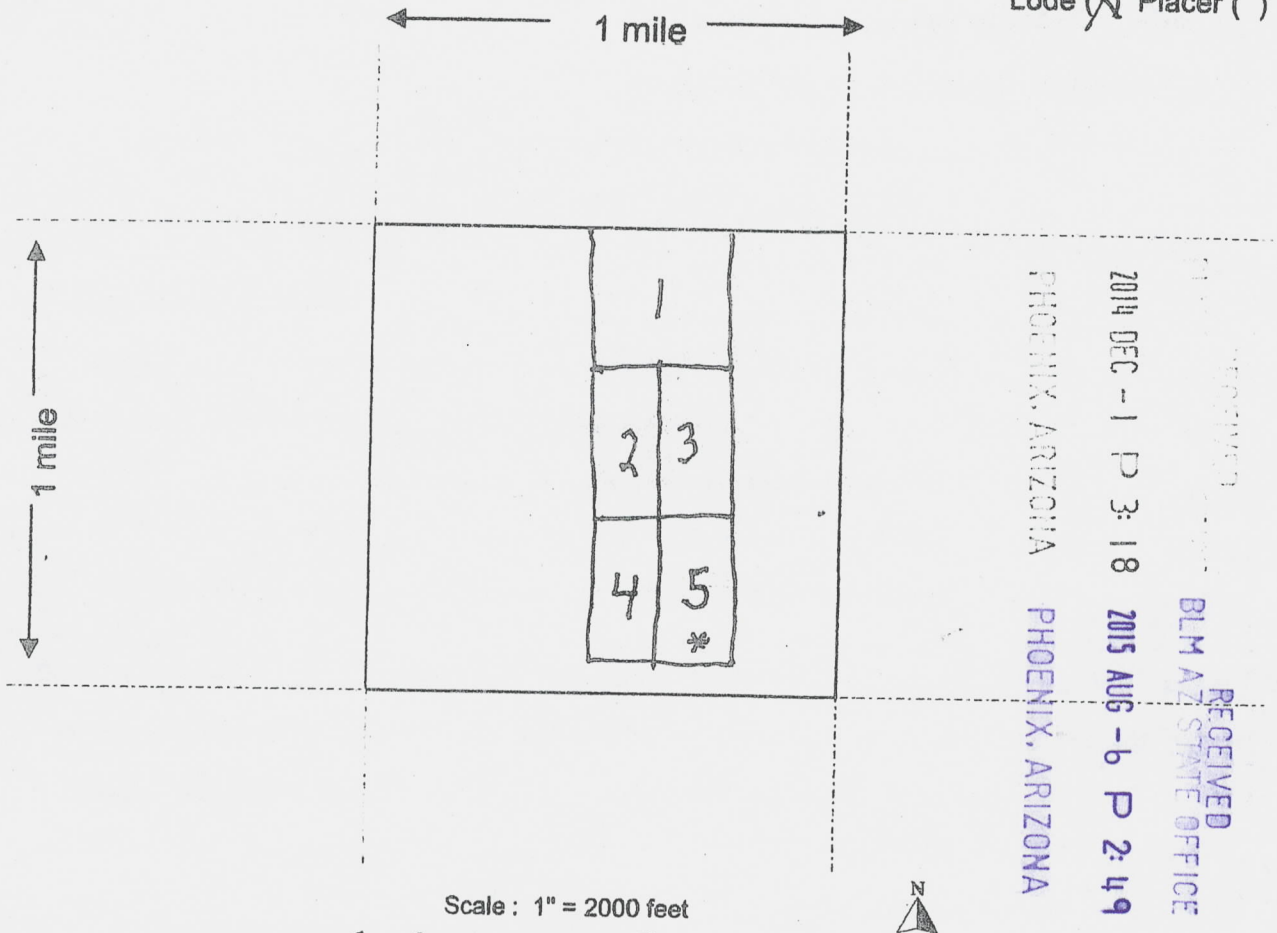

AMC430046

1. The above map depicts the GU RENEGADE 5 mining claim, which is located in Section (s) 23, Township 16 South, Range 23 EAST, Gila and Salt River Base and Meridian, COCHISE County, Arizona.

2. The type of corner and location monuments used are as follows: 2 3/8" STEEL PIPE  
4' LONG WITH CAPS

3. The bearings and distances in degrees and feet between claim corners are as depicted on the map.  
180° 1500', 90° 600', 360° 1500', 270° 600'

Form MCF100a  
Revised July 2005

This form is available from the Arizona Department of Mines & Mineral Resources and may be reproduced.

**LOCATION NOTICE FOR LODE MINING CLAIM**

NOTICE IS HEREBY GIVEN that the GV RENEGADE 5  
\_\_\_\_\_ lode mining claim has been located  
by David Ritter whose current mailing  
address is 13475 S Bell Rd  
Benson Az 85602

RECEIVED  
2014 DEC -1 P 3:17  
PHOENIX, ARIZONA  
BLM  
Date  
Stamp

The general course of this claim is NORTH-SOUTH and it is situated in COCHISE  
County, Arizona. This claim is 1500 feet in length and 600 feet in width. This claim runs  
from the location monument on which this location notice is posted approximately 10 feet in a  
SOUTH direction to the SOUTH end line and 300 feet in a EAST direction to the  
EAST end line. This claim is marked by six monuments, one at each corner and one at the center of each  
end line of the claim.

The location monument on which this notice is posted is situated within Section 23, Township 16  
SOUTH, Range 23 EAST, Gila Salt River Base and Meridian, Arizona and this claim encompasses portions  
of the following quarter section (s), section (s), Township (s) and Range (s) NW-SE 1/4 SECTION 23  
TOWNSHIP 16 SOUTH, RANGE 23 EAST

Gila Salt River Base and Meridian, Arizona.

The locality of this claim with reference to some natural object or permanent monument and additional information  
(if any) concerning its locality are as follows: \_\_\_\_\_  
\_\_\_\_\_  
\_\_\_\_\_

DATED AND POSTED on the ground this \_\_\_\_\_ day of \_\_\_\_\_, 20\_\_\_\_.

LOCATOR (s) David Ritter, Leroy Ritter  
Don Ritter Leroy Ritter

Form MCF100  
Revised July 2005

AMC430046

**MINING CLAIM MAP**

Lode (X) Placer ( )

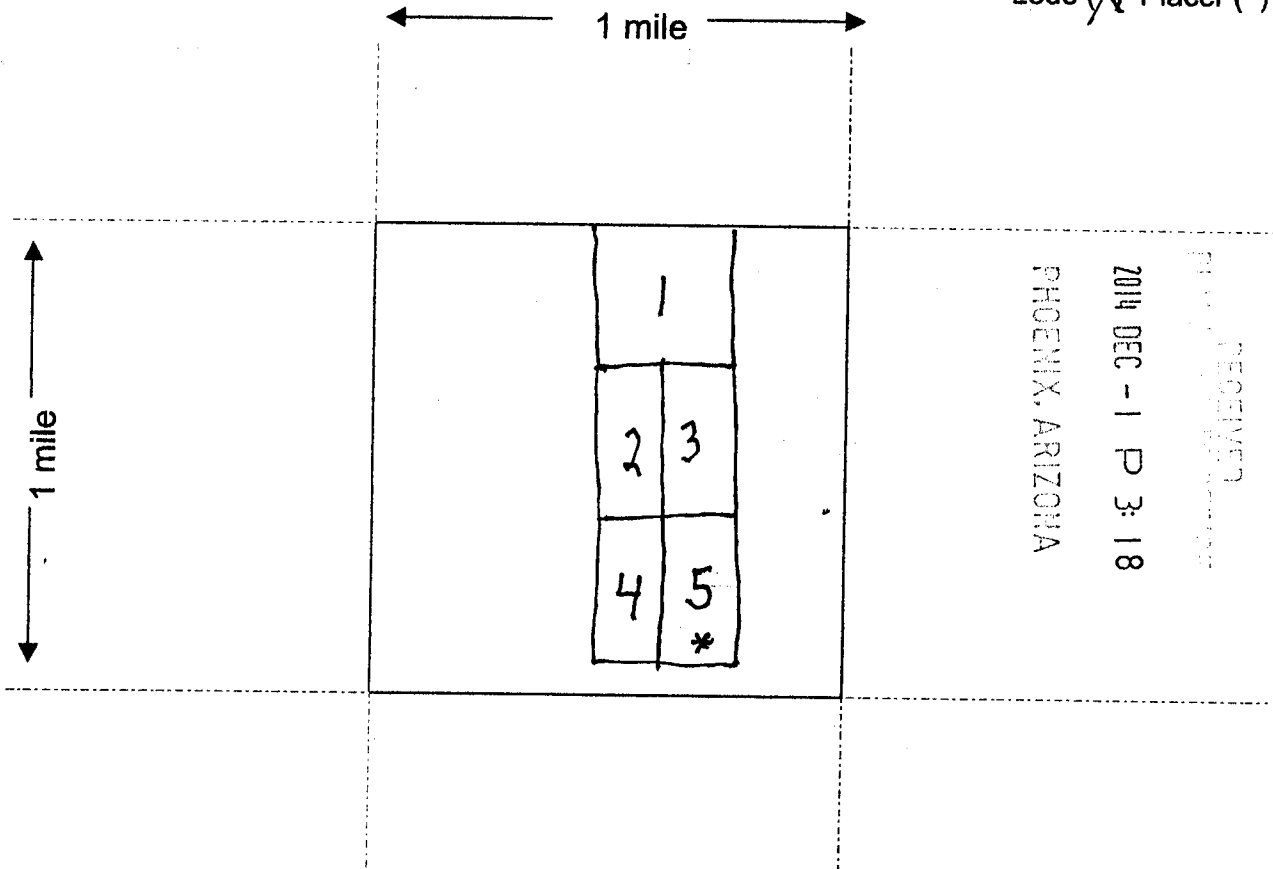

RECEIVED  
 2014 DEC -1 P 3:18  
 PHOENIX, ARIZONA

Scale : 1" = 2000 feet



1. The above map depicts the GU RENEGADE 5 mining claim, which is located in Section (s) 23, Township 16 South, Range 23 EAST, Gila and Salt River Base and Meridian, COCHISE County, Arizona.

2. The type of corner and location monuments used are as follows: 2 3/8" STEEL PIPE  
4' LONG WITH CAPS

3. The bearings and distances in degrees and feet between claim corners are as depicted on the map.

180° 1500', 90° 600', 360° 1500', 270° 600'

Form MCF100a  
 Revised July 2005

This form is available from the Arizona Department of Mines & Mineral Resources and may be reproduced.

AMC430046

When recorded, mail to:

Name: David Ritter

Address: 13475 S Bell Rd

City/State/Zip Code: Benson Az 85602

Space above this line for Recorder's use

### NOTICE OF MINING CLAIM

- 1. TYPE OF NOTICE:  Location  Amendment  Relocation
- 2. TYPE OF CLAIM:  Placer  Lode  Millsite  Tunnelsite

3. The name and address of the Locator is

Name: David Ritter

Address: 13475 S Bell Rd

City/State/Zip Code: Benson Az 85602

4. The name of the claim is GU RENEGADE 5

5. The date of the location is \_\_\_\_\_

6. The claim is 1500 feet long and 600 feet wide. The distance from the location monument to each end of the claim is 1500 feet in a SOUTH direction and 600 feet in a WEST direction.

7. The general course of the claim is from the NORTH to the SOUTH

8. The location of the claim is in Section NW-SE 23, Township 16 SOUTH

Range 23 EAST

GILA SALT RIVER

TERQUOISE

Base and Meridian

Mining District, COCHISE

County

State of ARIZONA

9. If amending or relocating, the previous claim name was \_\_\_\_\_

\_\_\_\_\_ recorded in Docket(Book) \_\_\_\_\_

\_\_\_\_\_ page(s) \_\_\_\_\_

State of \_\_\_\_\_

Mining District, \_\_\_\_\_

County, \_\_\_\_\_

10. The location of the claim with reference to a natural object or permanent monument is \_\_\_\_\_

Dated: 10-07-2014

David Ritter

Signature

13475 S Bell Rd

Address

Benson Az 85602

City/State/Zip

ANCH 30046

2014 DEC - 1 P 3:18  
PHOENIX ARIZONA

# OF MINING CLAIM LOCATION

- The name of the claim is GV RENEGADE 5
- The NORTH EAST corner of the claim is 300 feet in a SOUTH direction to a survey monument or permanent natural object described as \_\_\_\_\_
- The type of location monument is 2 3/8" STEEL PIPE 4 FT. LONG WITH CAP  
The type of corner end monuments are 2 3/4" STEEL PIPE 4 FT. LONG WITH CAP
- The bearing and distance between the corners of the claim are beginning at the NORTHEAST corner of the claim, 600 feet in a WEST direction to the NORTHWEST corner, then 1500 feet in a SOUTH direction to the SOUTHWEST corner, then 600 feet in a EAST direction to the SOUTH EAST corner, then 1500 feet in a NORTH direction to the point of beginning.

## MAP

One inch = One thousand feet

North Arrow



ONE MILE

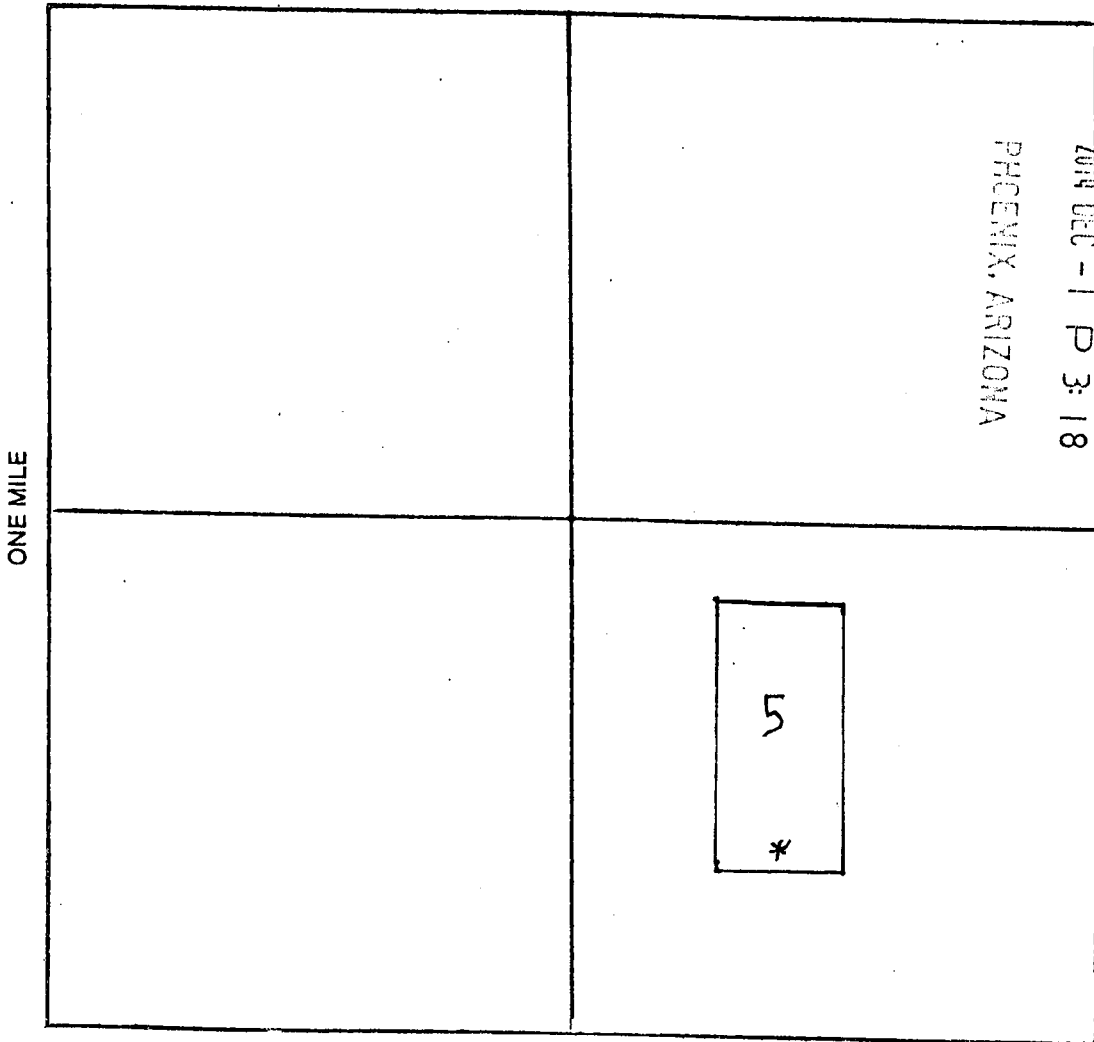

AMC430046

Section NW-SE 1/4 23 Range 23 EAST Township 16 SOUTH  
GILA SALT RIVER Base and Meridian.

Dated: 10-07-2014 [Signature]  
 Signature

CORRECTED

LOCATION NOTICE FOR LODE MINING CLAIM

NOTICE IS HEREBY GIVEN that the GV RENEGADE 4 lode mining claim has been located by David Ritter whose current mailing address is 13475 S Bell Rd Benson Az 85602

BLM Date Stamp  
2014 DEC - 1 P 3:17  
PHOENIX, ARIZONA

The general course of this claim is NORTH - SOUTH and it is situated in COCHISE County, Arizona. This claim is 1500 feet in length and 600 feet in width. This claim runs from the location monument on which this location notice is posted approximately 10 feet in a SOUTH direction to the SOUTH end line and 300 feet in a EAST direction to the EAST end line. This claim is marked by six monuments, one at each corner and one at the center of each end line of the claim.

The location monument on which this notice is posted is situated within Section 23, Township 16 SOUTH, Range 23 EAST, Gila Salt River Base and Meridian, Arizona and this claim encompasses portions of the following quarter section (s), section (s), Township (s) and Range (s) NW-SE 1/4 SECTION 23 TOWNSHIP 16 SOUTH, RANGE 23 EAST

Gila Salt River Base and Meridian, Arizona.

The locality of this claim with reference to some natural object or permanent monument and additional information (if any) concerning its locality are as follows:

RECEIVED  
BLM AT STATE OFFICE  
25 AUG - 6 P 2:48  
PHOENIX, ARIZONA

DATED AND POSTED on the ground this 1 day of Oct, 2014.

LOCATOR (s) David Ritter, Leroy Ritter  
David Ritter Leroy Ritter

Form MCF100  
Revised July 2005

This form is available from the Arizona Department of Mines & Mineral Resources and may be reproduced.

ENTERED  
AUG 15 2015  
BY: [Signature]

AMC430045

**MINING CLAIM MAP**

Lode  Placer ( )

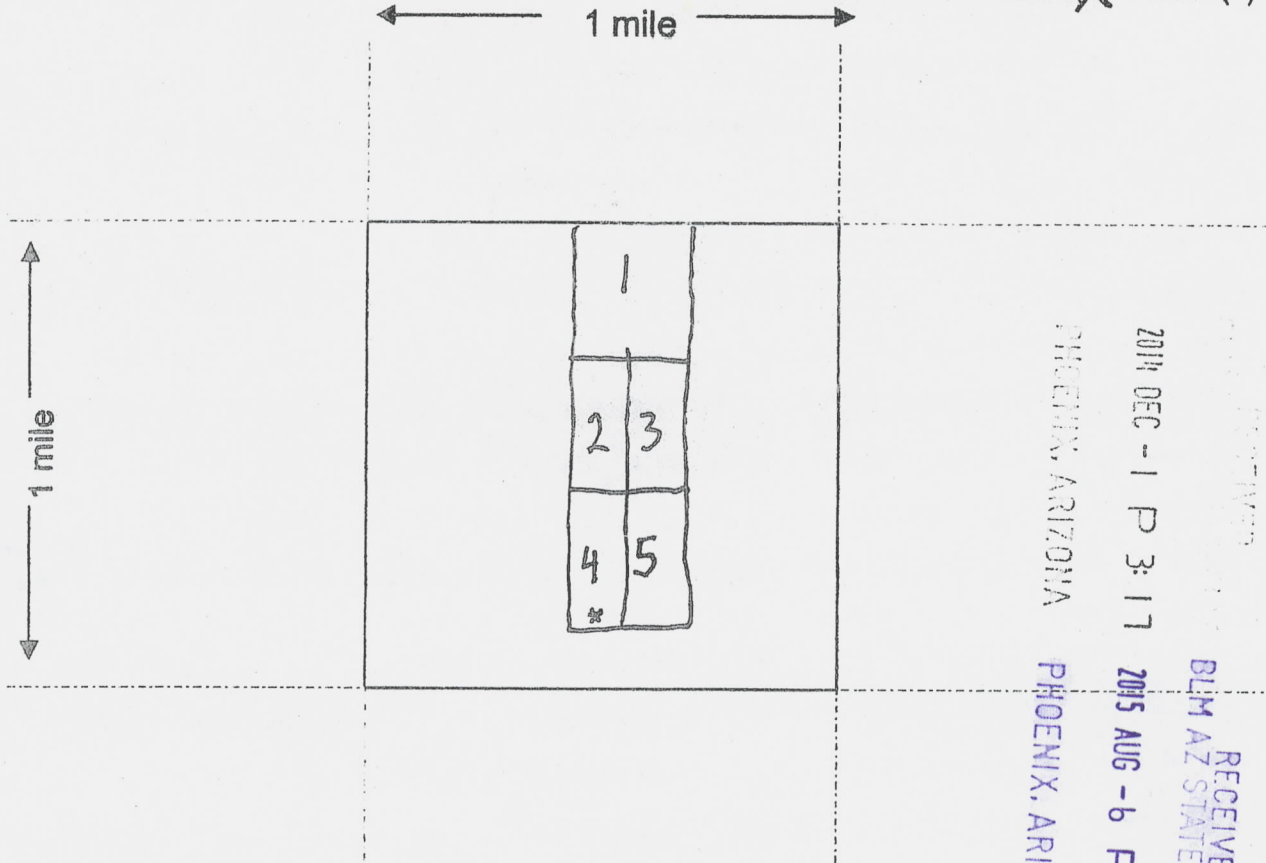

Scale : 1" = 2000 feet

1. The above map depicts the GU RENEGADE 4 mining claim, which is located in Section (s) 23, Township 16 SOUTH, Range 23 EAST, Gila and Salt River Base and Meridian, COCHISE County, Arizona.

2. The type of corner and location monuments used are as follows: 2 3/8" STEEL PIPE  
4' LONG WITH CAPS

3. The bearings and distances in degrees and feet between claim corners are as depicted on the map.

180° 1500', 90° 600', 360° 1500', 270° 600'

Form MCF100a  
Revised July 2005

This form is available from the Arizona Department of Mines & Mineral Resources and may be reproduced.



**LOCATION NOTICE FOR LODE MINING CLAIM**

NOTICE IS HEREBY GIVEN that the GU RENEGADE 4  
\_\_\_\_\_ lode mining claim has been located  
by David Ritter whose current mailing  
address is 13475 S Bell Rd  
Benson Az 85602

BLM  
Date  
Stamp  
2014 DEC - 1 P 3: 17  
PHOENIX, ARIZONA

The general course of this claim is NORTH - SOUTH and it is situated in COCHISE  
County, Arizona. This claim is 1500 feet in length and 600 feet in width. This claim runs  
from the location monument on which this location notice is posted approximately 10 feet in a  
SOUTH direction to the SOUTH end line and 300 feet in a EAST direction to the  
EAST end line. This claim is marked by six monuments, one at each corner and one at the center of each  
end line of the claim.

The location monument on which this notice is posted is situated within Section 23, Township 16  
SOUTH, Range 23 EAST, Gila Salt River Base and Meridian, Arizona and this claim encompasses portions  
of the following quarter section (s), section (s), Township (s) and Range (s) NW-SE 1/4 SECTION 23  
TOWNSHIP 16 SOUTH, RANGE 23 EAST

Gila Salt River Base and Meridian, Arizona.

The locality of this claim with reference to some natural object or permanent monument and additional information  
(if any) concerning its locality are as follows: \_\_\_\_\_  
\_\_\_\_\_  
\_\_\_\_\_

DATED AND POSTED on the ground this \_\_\_\_\_ day of \_\_\_\_\_, 20\_\_\_\_.

LOCATOR (s) David Ritter, Leroy Ritter  
David Ritter Leroy Ritter

Form MCF100  
Revised July 2005

AMC430045

MINING CLAIM MAP

Lode (X) Placer ( )

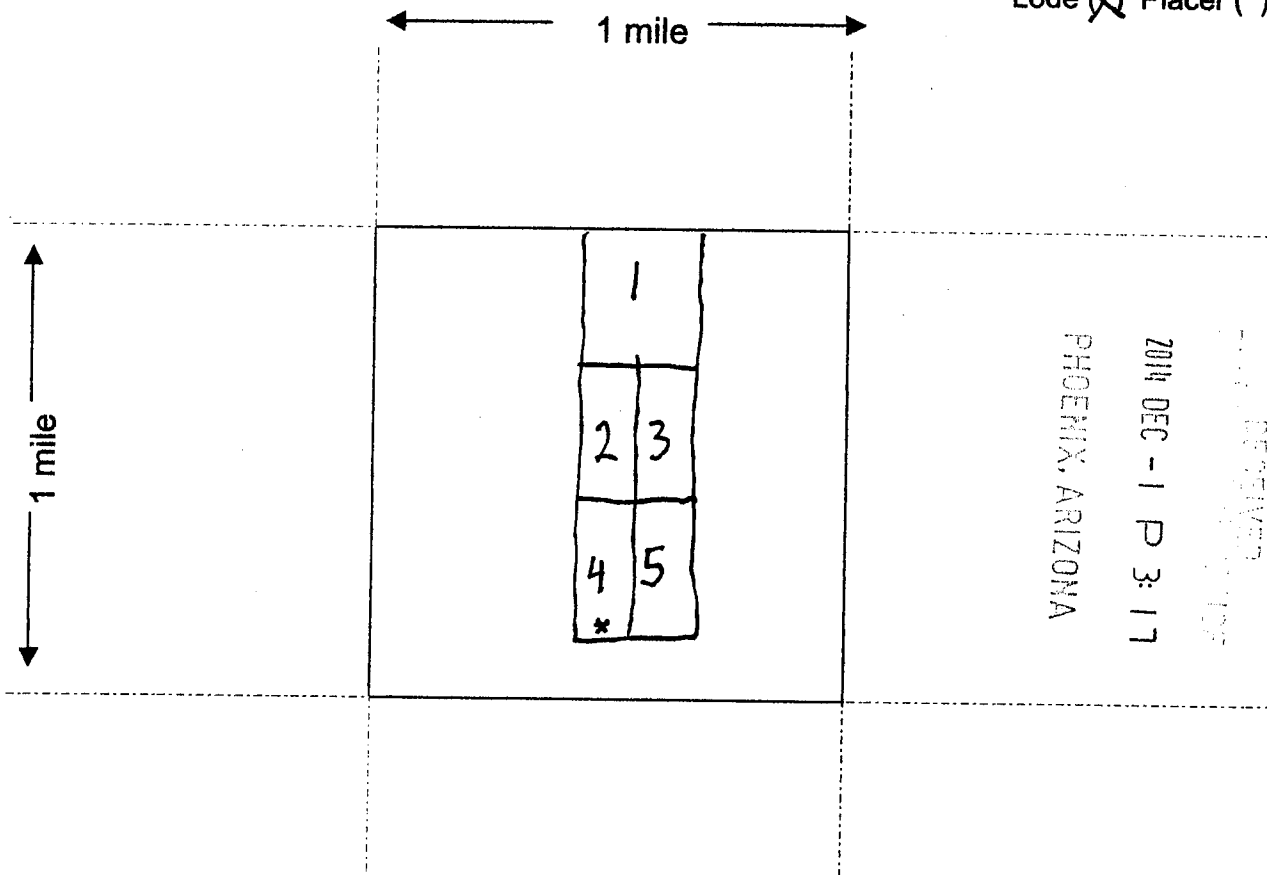

Scale : 1" = 2000 feet



1. The above map depicts the GU RENEGADE 4 mining claim, which is located in Section (s) 23, Township 16 SOUTH, Range 23 EAST, Gila and Salt River Base and Meridian, COCHISE County, Arizona.

2. The type of corner and location monuments used are as follows: 2 3/8" STEEL PIPE  
4' LONG WITH CAPS

3. The bearings and distances in degrees and feet between claim corners are as depicted on the map.

180° 1500', 90° 600', 360° 1500', 270° 600'

Form MCF100a  
Revised July 2005

This form is available from the Arizona Department of Mines & Mineral Resources and may be reproduced.

AMC430045

When recorded, mail to:

Name: David Ritter

Address: 13475 S Bell Rd

City/State/Zip Code: Benson Az 85602

Space above this line for Recorder's use

### NOTICE OF MINING CLAIM

- 1. TYPE OF NOTICE:  Location  Amendment  Relocation
- 2. TYPE OF CLAIM:  Placer  Lode  Millsite  Tunnelsite

3. The name and address of the Locator is

Name: David Ritter

Address: 13475 S Bell Rd

City/State/Zip Code: Benson Az 85602

4. The name of the claim is GU RENEGADE 4

5. The date of the location is \_\_\_\_\_

6. The claim is 1500 feet long and 600 feet wide. The distance from the location monument to each end of the claim is 1500 feet in a SOUTH direction and 600 feet in a WEST direction.

7. The general course of the claim is from the NORTH to the SOUTH

8. The location of the claim is in Section NW-SE 4 23, Township 16 South

Range 23 EAST  
GILA SALT RIVER

TERQUOISE

Base and Meridian,  
County,

State of ARIZONA Mining District, COCHISE

9. If amending or relocating, the previous claim name was \_\_\_\_\_ recorded in Docket(Book) \_\_\_\_\_ page(s) \_\_\_\_\_

State of \_\_\_\_\_ Mining District, \_\_\_\_\_ County,

10. The location of the claim with reference to a natural object or permanent monument is \_\_\_\_\_

Dated: 10-07-2014

David Ritter  
Signature

13475 S Bell Rd  
Address

Benson Az 85602  
City/State/Zip

PHOENIX, ARIZONA  
2014 DEC - 1 P 3:17

# M OF MINING CLAIM LOCATION

- The name of the claim is GV RENEGADE 4
- The NORTH corner of the claim is 300 feet in a SOUTH direction to a survey monument or permanent natural object described as \_\_\_\_\_
- The type of location monument is 2 3/8" STEEL PIPE 4 FT. LONG WITH CAP  
The type of corner end monuments are 2 3/8" STEEL PIPE 4 FT. LONG WITH CAP
- The bearing and distance between the corners of the claim are beginning at the NORTH EAST corner of the claim, 600 feet in a WEST direction to the NORTH WEST corner, then 1500 feet in a SOUTH direction to the SOUTH WEST corner, then 600 feet in a EAST direction to the SOUTH EAST corner, then 1500 feet in a NORTH direction to the point of beginning.

## MAP

One inch = One thousand feet

North Arrow



ONE MILE

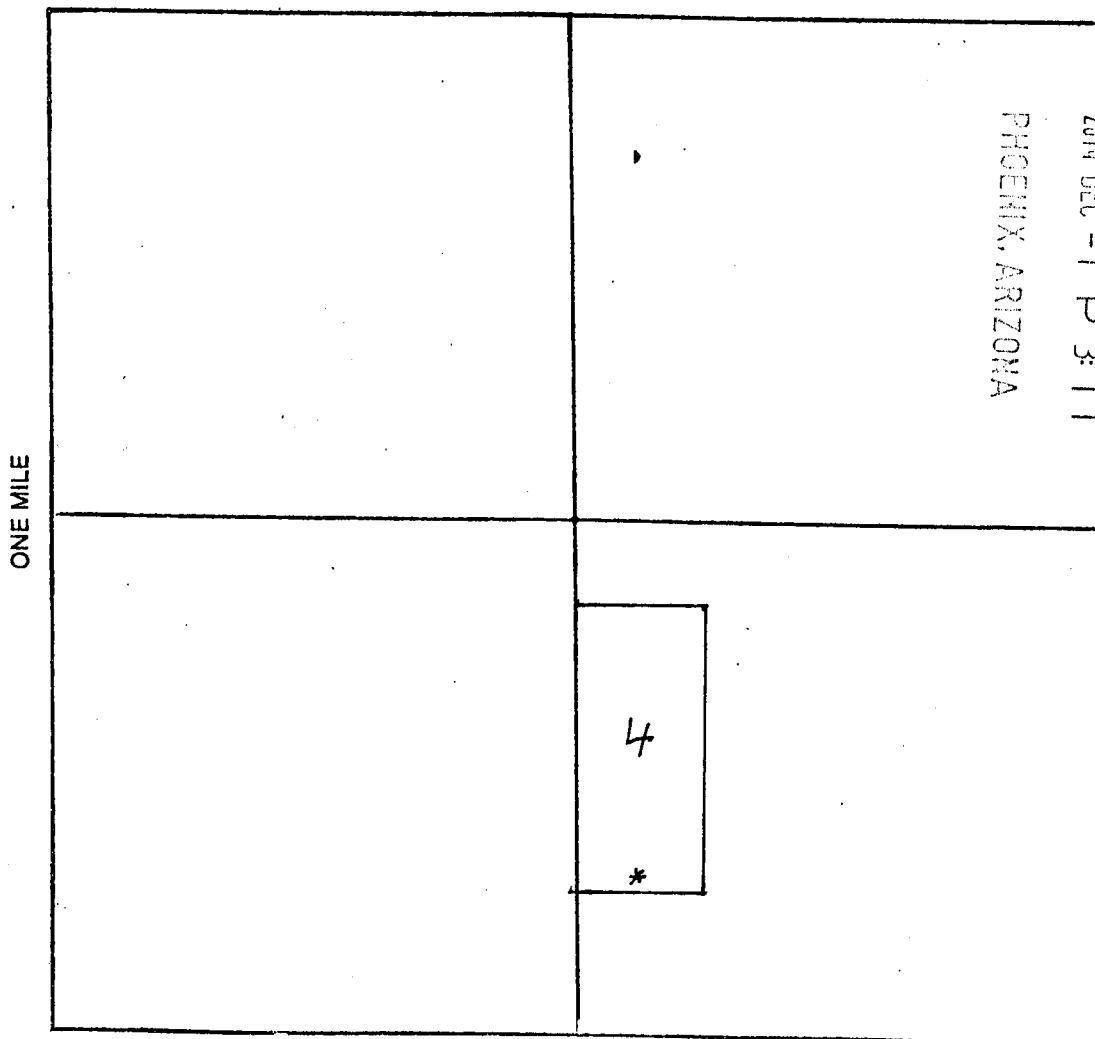

RECEIVED  
2014 DEC - 1 P 3 11  
640 ACRES

AMC430045

Section NW-SE 1/4 23 Range 23 EAST Township 16 SOUTH  
GILA SALT RIVER Base and Meridian.

Dated: 10-07-2014

[Signature]

Signature

DEPARTMENT OF INTERIOR  
BUREAU OF LAND MANAGEMENT

Input Parameters for Geographic Report with Land

System Id = CR

Admin State = AZ

Geo State =

Casetype Begins With

Case Disp Txt = AUTHORIZED, CANCELLED, EXPIRED, PENDING, REJECTED, RELINQUISHED, WITHDRAWN

Mer Twp Rng =

Section =

Mtrs = 14 0160S 0230E 023, 14 0160S 0230E 999

Commodity =

Commodity Txt =

Pending Org =

Pend Org Decode =

Total Rows Returned: 7

RUN TIME: 08:39 AM

UNITED STATES DEPARTMENT OF INTERIOR  
BUREAU OF LAND MANAGEMENT  
GEOGRAPHIC REPORT WITH LAND  
Sorted by Serial Number

RUN DATE: 12/09/2014  
Page 1 of 1

Adm State: AZ

Serial Number: AZA 007428  
Total Case Acres: 32.559

<u>Casetype</u>	<u>Case Disp</u>	14	0160S	0230E	<u>Sect</u>	<u>Sur Typ</u>	<u>Sur Num</u>	<u>Suff</u>	<u>Subdivision</u>	<u>Act Pend</u>
285002	AUTHORIZED				023	ALIQ LOTS			W2NE,SENW; 2;	

Serial Number: AZA 019983  
Total Case Acres: 1.000

<u>Casetype</u>	<u>Case Disp</u>	14	0160S	0230E	<u>Sect</u>	<u>Sur Typ</u>	<u>Sur Num</u>	<u>Suff</u>	<u>Subdivision</u>	<u>Act Pend</u>
282201	AUTHORIZED				023	LOTS			2;	

Serial Number: AZA 022099  
Total Case Acres: 0.080

<u>Casetype</u>	<u>Case Disp</u>	14	0160S	0230E	<u>Sect</u>	<u>Sur Typ</u>	<u>Sur Num</u>	<u>Suff</u>	<u>Subdivision</u>	<u>Act Pend</u>
281001	AUTHORIZED				023	ALIQ			NESE;	

Serial Number: AZAR 0000438  
Total Case Acres: 5.740

<u>Casetype</u>	<u>Case Disp</u>	14	0160S	0230E	<u>Sect</u>	<u>Sur Typ</u>	<u>Sur Num</u>	<u>Suff</u>	<u>Subdivision</u>	<u>Act Pend</u>
285004	AUTHORIZED				023	ALIQ			N2NE;	

Serial Number: AZAR 0035743  
Total Case Acres: 2.550

<u>Casetype</u>	<u>Case Disp</u>	14	0160S	0230E	<u>Sect</u>	<u>Sur Typ</u>	<u>Sur Num</u>	<u>Suff</u>	<u>Subdivision</u>	<u>Act Pend</u>
285002	AUTHORIZED				023	FF LOTS		1 2	W2NE,E2NW; 2;	

TOWNSHIP 16 SOUTH RANGE 23 EAST OF THE GILA AND SALT RIVER MERIDIAN, ARIZONA

COCHISE COUNTY

STATUS OF PUBLIC DOMAIN  
LAND AND MINERAL TITLES

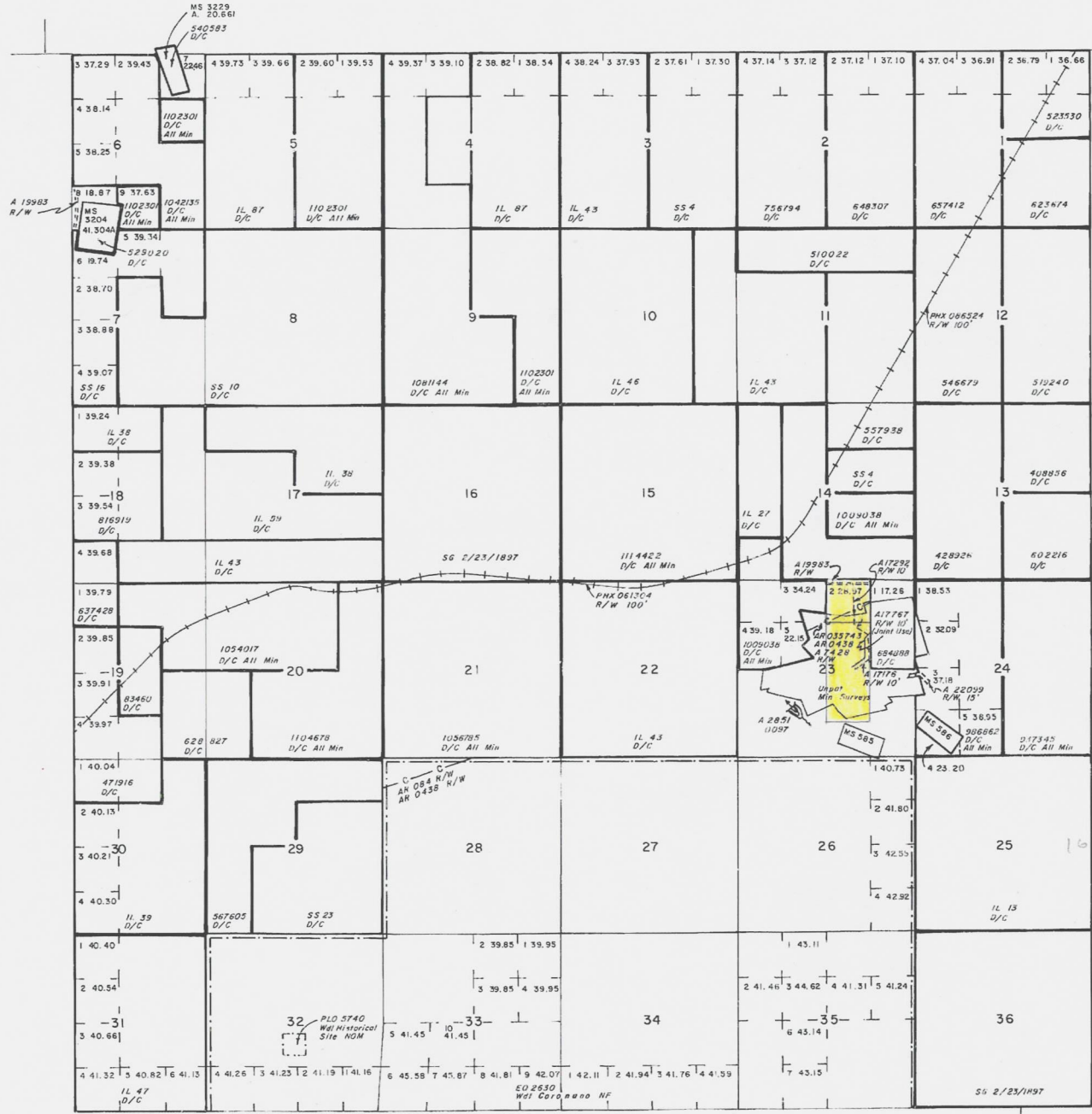

INDEX TO SEGREGATED TRACTS

RESURVEY TRACT NO	ORIGINAL SURVEY		
	T	R	SUBDIVISION

FOR ORDERS EFFECTING DISPOSAL OR USE OF UNIDENTIFIED LANDS WITHINAM FOR CLASSIFICATION, MINERALS, WATER AND/OR OTHER PUBLIC PURPOSES, REFER TO INDEX OF MISCELLANEOUS DOCUMENTS.

DIST NO. 4

MDS 782 NE  
783 NW  
784 SW  
785 SE

AZA 24124 SX Apla NOM  
Sec 23, 24 For Exceptions to Unpat MS Sec  
F.R. 12 / 1987

Lot. 3°59'36"N  
Long. 109°56'4"W

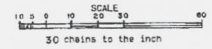

WARNING STATEMENT  
This plat is the Bureau's record of title, and should be used only as a graphic display of the township survey data. Records herein do not reflect title changes which may have been effected by lateral movements of rivers or other bodies of water. Refer to the cadastral surveys for official survey information.

CURRENT TO	BY

T. 16 S.  
R. 23 E.

D Ritter  
13475 S Bell Rd  
Benson Az 85602

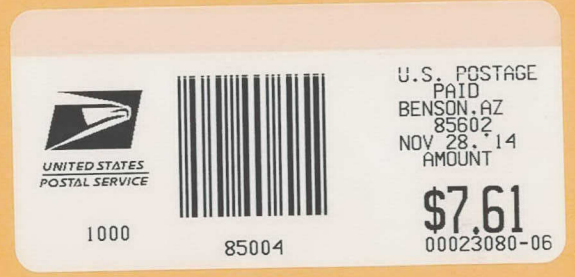

RECEIVED  
BLM AZ STATE OFFICE  
2014 DEC -1 P 3: 16  
PHOENIX, ARIZONA

Bureau of Land Management  
Arizona State office  
One North Central Ave Ste 800  
Phoenix Az 85004-4427

